

# **FRAZIER PARK PUBLIC UTILITY DISTRICT**

---

*Engineer's Formation and Annual Levy Report For:*  
**Water Standby Assessment District No. 2025-1**

**February 2025**



[nbsgov.com](http://nbsgov.com)

# TABLE OF CONTENTS

---

<b>1. Engineer’s Statement.....</b>	<b>1</b>
<b>2. Introduction .....</b>	<b>2</b>
2.1 District History.....	2
2.2 Legislative Context .....	2
2.3 Court Rulings .....	3
<b>3. Improvements .....</b>	<b>5</b>
3.1 Water System Condition .....	5
3.2 Standby Charge Improvements.....	5
<b>4. Method of Apportionment.....</b>	<b>7</b>
4.1 General and Special Benefit .....	7
4.2 Apportionment Formula .....	8
4.3 Exemptions.....	8
<b>5. Budget.....</b>	<b>9</b>
5.1 Compilation of the Assessment .....	9
5.2 Annual Escalator.....	9
5.3 Data for Annual Assessment Calculations.....	10
5.4 Future Changes of a Parcel’s Development Status .....	10
5.5 Appeals .....	10
5.6 Method of Collection .....	11
<b>6. Assessment Diagram.....</b>	<b>12</b>
<b>7. Assessment Roll.....</b>	<b>13</b>
<b>8. References.....</b>	<b>14</b>



# 1. Engineer's Statement

The Frazier Park Public Utilities District Water Standby Charge Assessment District 2025-1 (the "Assessment District") described in this Report has been prepared pursuant to Article XIII D of the California Constitution. In preparing these assessments:

1. I have identified all parcels that will have a special benefit conferred upon them by the Improvements described in Section 3 of this Report (the "Specially Benefited Parcels").
  - a. For particulars as to the identification of these parcels, reference is made to the Assessment Diagram, a copy of which is included in Section 6 of this Report.
2. I have assessed the estimated costs and expenses of the Improvements upon the Specially Benefited Parcels. In making such assessment:
  - a. The proportionate special benefit derived from the Improvements by each Specially Benefited Parcel was determined in relationship to the entirety of the cost of the Improvements;
  - b. No assessment has been imposed on any Specially Benefited Parcel which exceeds the reasonable cost of the proportional special benefit conferred on such parcel by the Improvements; and
  - c. The general benefits have been separated from the special benefits and only special benefits have been assessed.

I, the undersigned, respectfully submit this Engineer's Report and, to the best of my knowledge, information and belief, this Report, the assessments, and the Assessment Diagram herein have been prepared and computed in accordance with the Assessment Law.

By: John G. Egan 2/28/2025  
John G. Egan  
Assessment Engineer  
R.C.E. 14853

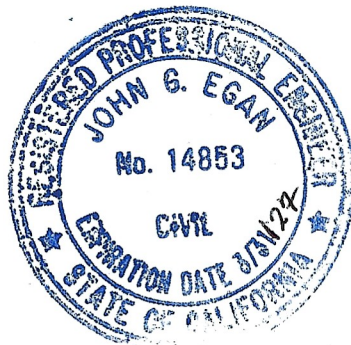

## 2. Introduction

---

### 2.1 District History

The Frazier Park Public Utility District (the “PUD”), County of Kern, State of California, desires to fund certain water services through a standby assessment as further described below. The proposed assessment is subject to the substantive and procedural requirements described in Section 4, Article XIII D of the California Constitution (“Article XIII D”). The assessment is authorized pursuant to the provisions of the Uniform Standby Charge Procedures Act, Division 2, Part 1 of the California Government Code of the State of California (commencing with Section 54984) (the “Act”).

The PUD operates a water extraction, treatment and distribution system for residents in the community of Frazier Park, California. The PUD is located approximately 46 miles south of Bakersfield, CA along interstate-5 in Kern County. The purpose of the existence and construction of these facilities and, therefore, the responsibility of the PUD, is to provide potable water to the properties within the PUD.

The PUD obtains its supply of water from underlying ground waters. The PUD’s system consists of two active wells, two inactive springs, pumping facilities, chlorination treatment at the well sites, ten storage tanks with a total volume of approximately two million gallons, and distribution piping.

The Board of Directors (the “Board”) of the PUD, in partnership with Self Help Enterprises, directed NBS Government Finance Group, DBA: NBS, to prepare and file a report (the “Report”) presenting the specifications describing the general nature and location of the facilities and an estimate of the costs of the maintenance and operations for the facilities for the Assessment District for Fiscal Year 2025/26. The Report includes an assessment of the estimated costs of the maintenance and operations of the facilities, the apportionment methodology and the net amount upon all assessable parcels within the Assessment District.

The PUD currently levies a standby charge authorized by the Act. It is charged to unimproved properties without service, or property with service locked off for more than 6 months. The current standby charge is \$5 per parcel per year. The Assessment District proposed in this Report, if approved by the Board and the property owners, will replace and supplant the existing standby charge.

Following the Board’s review and acceptance of the Report, the Board may initiate proceedings to fix the assessment per California Government Code Section 54984.3. The proceedings also include compliance with California Government Code Section 53753, which requires a public hearing and property owner protest via mailed ballots. Upon approval of the property owners, the Board may order the levy and collection of the assessment and cause it to be submitted to the Kern County Auditor-Controller and included on the property tax roll for Fiscal Year 2025/26.

### 2.2 Legislative Context

In 1996, California voters adopted Proposition 218, known as the “Right to Vote on Taxes Act,” which added Articles XIII C and XIII D to the California Constitution. Article XIII D established new substantive and procedural requirements on agencies for levying assessments, being levies on real property by an agency for a special benefit conferred upon the real property. “Special benefit” is defined in Article XIII D as “a

particular and distinct benefit over and above general benefits conferred on a real property located in the District or to the public at large.”

Article XIII D imposes five basic substantive requirements on assessments:

- (1) All parcels that will have a special benefit conferred upon them and upon which an assessment will be imposed must be identified;
- (2) The general benefits must be distinguished from the special benefits conferred on the parcels;
- (3) The proportionate special benefit derived by each identified parcel must be determined in relationship to the entirety of the capital cost of a public improvement, the maintenance and operation expenses of a public improvement, or the cost of the property-related service being provided;
- (4) The amount assessed to a parcel must not exceed the reasonable cost of the proportional special benefit conferred on that parcel and must not include any costs attributable to the general benefit; and
- (5) Parcels within a District that are owned or used by any agency, the State of California or the United States shall not be exempt from assessment unless the agency can demonstrate by clear and convincing evidence that those publicly owned parcels in fact receive no special benefit.

Article XIII D also imposes procedural requirements on assessments, which include preparing an engineer’s report, providing written notice of the proposed assessment and public hearing to property owners, holding a public hearing, and providing for a protest ballot proceeding.

## 2.3 Court Rulings

Since the initial passage of Proposition 218, several court rulings have helped provide context and direction with respect to the procedures and requirements of Article XIII D for levying assessments. Several of the key concepts from these rulings are summarized below.

### GENERAL BENEFIT

Article XIII D requires an agency to separate the general benefits from the special benefits conferred on the identified parcels because only special benefits are assessable.

The Court of Appeal in *Golden Hills Neighborhood Assn., Inc. v. City of San Diego* (2011) (“*Golden Hills*”) clarified this concept by stating, “*Separation and quantification of general and special benefits must be accomplished by apportioning the cost of a service or improvement between the two and assessing property owners only for the portion of the cost representing special benefits.*”

The Court of Appeal in *Beutz v. County of Riverside* (2010) (“*Beutz*”) noted that the trial court took judicial notice of the Legislative Analyst’s Office pamphlet titled “Understanding Proposition 218” which states an agency must “*estimate the amount of special benefit landowners would receive from the project or service, as well as the amount of ‘general benefit.’ This step is needed because Proposition 218 allows local government to recoup from assessments only the proportionate share of cost to provide the special benefit.*”

The Court in *Beutz* furthered this idea stating, *“Separating the general from the special benefits of a public improvement project and estimating the quantity of each in relation to the other is essential if an assessment is to be limited to the special benefits.”*

The Court of Appeal in *Silicon Valley Taxpayers' Association Incorporated v. Santa Clara County Open Space Authority* (2008) clarified that general benefits are not restricted to benefits conferred only on persons and property outside the assessment district but can include benefits both conferred on real property located in the District or to the public at large. The court defined the “public at large” as comprising all members of the public, including those who live, work, and shop within the District, and not simply transient visitors.

The Court of Appeal again reiterated the need to separate, quantify and apportion costs to general benefits from the improvements in *Broad Beach Geologic Hazard Abatement District v 31506 Victoria Point LLC* (2022), stating, *“The District cites no authority, and we are aware of none, suggesting that an agency’s subjective intent determines the need to account for general benefits.”*

### **BENEFIT-BASED NOT COST-BASED**

In *Town of Tiburon v. Bonander* (2009) (*“Tiburon”*), the Court of Appeal clarified the idea that assessments must be apportioned based upon benefit rather than cost. The Court stated, *“Proportionate special benefit is the basis upon which a project’s total assessable costs are apportioned among parcels within an assessment District.”*

The assessment on a particular property cannot be based on the relative cost of the improvements to the property, but rather on the special benefit conferred on such property. The Court in *Tiburon* also stated, *“an assessment represents the entirety of the cost of the improvement or property-related service, less any amount attributable to general benefits (which may not be assessed), allocated to individual properties in proportion to the relative special benefit conferred on the property.”*

### **MEASURING AND APPORTIONING SPECIAL BENEFIT**

The Court in *Tiburon* acknowledged the difficulty of trying to precisely assign and measure special benefit, stating, *“Any attempt to classify special benefits conferred on particular properties and to assign relative weights to those benefits will necessarily involve some degree of imprecision.”*

The Court in *Tiburon* went on to say that a formula assigning equal weight to different special benefits *“may be a legally justifiable approach to measuring and apportioning special benefits, [but] it is not necessarily the only valid approach. Whichever approach is taken to measuring and apportioning special benefits, however, it must be both defensible and consistently applied.”*

## 3. Improvements

---

The PUD's infrastructure system can be grouped into three main categories as outlined below.

1. Supply – consisting of two water wells
2. Storage – consisting of ten water tanks
3. Distribution – consisting of several miles of water pipelines

### 3.1 Water System Condition

The PUD's water system is aging and in need of repair and rehabilitation to continue to operate. The PUD's water supply comes from two wells, one of which is in the process of failing. This failing well provides the majority of the water to Frazier Park residences and businesses. Due to this eminent total failure, the PUD needs to drill an additional well. Also, two water storage tanks are corroding and are experiencing continuous leaks. Both of these tanks need to be replaced to protect the PUD's potable supply. Lastly, there are approximately 20 miles of steel waterlines which are corroding and leaking throughout the system. These waterlines need to be replaced and upgraded to current standards.

The supply, storage, and distribution system requires substantial maintenance, repair, and rehabilitation. These system wide infrastructure needs are critical to the PUD's continued operation. The PUD is pursuing various grants and other funding solutions for these known needed repairs and improvements.

Currently, costs not covered by the proposed Assessment District are covered by the PUD's monthly water service fixed costs and the existing standby charge. If the proposed Assessment District is approved, it will result in the discontinuation of the existing standby charge.

### 3.2 Standby Charge Improvements

The proposed Assessment described in this Report will fund the following:

- The contribution to the maintenance and repair of the water system which is necessary to provide for future water service connections.

The maintenance and repair activities listed above are collectively referred to as the "Improvements". Funding the Improvements is necessary to keep the water system functioning so that the water system will be unable to provide future connections necessary to facilitate a parcel's future development.

A general illustration of the location of the Improvements is shown below.





## 4. Method of Apportionment

---

### 4.1 General and Special Benefit

Only special benefits are assessable and in order to assess only special benefits, the general benefits conferred by the Improvements must be separated and quantified. However, the general public does not benefit or hold right to the Improvements described within this Report and only those parcels within the Assessment District for which the assessment is proposed receive benefit.

The PUD does not receive or supply water to any agency or property outside of the PUD's jurisdictional boundary and the PUD's water service is available and reserved solely for properties within the PUD. Consequently, the PUD's water service specially benefits only the parcels within the Assessment District for which the assessment is proposed to be levied. There is no general benefit derived by the proposed Assessment District.

Since a water meter must be installed by the PUD in order to develop a parcel, the special benefit received by developable parcels is the ability to access the PUD's water system. The size of the water meter drives the overall system design requirements and is a component of the proportional load that a parcel will place on the PUD's system. This proportional load indicated by water meter size is directly proportional to the special benefit (share of system capacity) a parcel will enjoy by facilitating its development.

Special benefit is first related to the development potential of each parcel and then to the parcel's anticipated water meter size. Parcels are placed into one of three development categories as defined below.

**Developed Parcel** is defined as a parcel that is connected to the PUD's system and is paying a monthly water meter charge. These parcels do not receive special benefit as they are already connected to the system and paying system costs.

**Undevelopable Parcel** is defined as property that has no development potential such that there is no prospect for the property to ever have a demand for water service. This may include roadways, easements, conservation areas, habitat lands, open space areas, or other non-taxable properties. The PUD shall determine each year which parcels are undevelopable. These parcels shall be exempt from the assessment. See Section 4.3 Exemptions.

**Developable Parcel** is defined as any parcel with the potential for future development necessitated by the installation of, or connection to, a water meter. These parcels receive special benefit and are subject to the assessment.

Kern County's Building Code requires a minimum 1" water meter for all developments. It is anticipated that nearly all Developable Parcels will require a 1" water meter and only a de minimis number of Developable Parcels might require a water meter greater than 1". Therefore, all future water meters are considered to be 1" and equal. Consequently, the proportionate load on the system and the proportionate special benefit received by each Developable Parcel will be equal.

Developed Parcels currently connected to the PUD's system will not be assessed as they already pay a monthly water meter charge which is used for system maintenance and improvements. Parcels which are

considered Undevelopable Parcels will not be assessed as they will not access the PUD’s water system and therefore have no special benefit. See Section 4.3 Exemptions.

## 4.2 Apportionment Formula

The assessment is determined by:

1. Parcel Development Status
  - a. Developable – Assessed
  - b. Developed – Not Assessed
  - c. Undevelopable – Exempt
2. Anticipated Water Meter Size
  - a. All Developable parcels’ anticipated Water Meter Size is 1”

All Developable Parcels will be charged equally each year up to the maximum annual assessment.

## 4.3 Exemptions

The PUD proposes to assess and collect from each benefiting property an amount related to the special benefit received. BLM lands and other publicly owned lands are, for practical purposes, not developable and therefore not subject to the Assessment District. The PUD proposes to clarify that any such public lands, which are not currently connected to the PUD’s water system, shall not be entitled to connect to the PUD's water system or to receive water service from the PUD in the future, unless a catch-up fee is paid which is equivalent to the assessment which would have been assessed against the property (starting in FY2025/26 and forward) had it not been exempt.

## 5. Budget

The cost of contribution to the maintenance and repair of the water system which is necessary to provide for future water service connections and expenses incidental thereto are summarized as follows.

**Table 1. Fiscal Year 2025/26 Estimated Budget**

Description	Amount
<b>DIRECT COSTS</b>	
System Repair & Maintenance	\$53,529.00
Capital Improvement Program – Including securing supply	53,529.00
<b>TOTAL DIRECT COSTS</b>	<b>\$107,058.00</b>
<b>INDIRECT COSTS</b>	
Professional Services/Contracts	\$6,500.00
District Administrative Charges	6,250.00
<b>TOTAL INDIRECT COSTS</b>	<b>\$12,750.00</b>
<b>TOTAL COST OF IMPROVEMENTS</b>	<b>\$119,808.00</b>
<b>Maximum Assessment per Parcel for Fiscal Year 2025/26</b>	<b>\$96.00</b>

### 5.1 Compilation of the Assessment

There are a total of 2,591 parcels within the Assessment District, 1,285 receive water service from the PUD and are considered Developed Parcels, 1,248 are Developable Parcels which are assessable, and 58 parcels are considered Undevelopable Parcels.

Initial Annual Assessment per Developable Parcel (FY2025/26): \$96

Total Assessment (FY2025/26): \$96 per Developable Parcel x 1,248 Parcels = \$119,808

### 5.2 Annual Escalator

The initial maximum annual assessment amount per Developable Parcel in FY2025/26 is \$96.00. As part of the assessment methodology, the maximum annual assessment shall be escalated each subsequent year over the previous year's maximum annual assessment on July 1 by the greater of a) 2% per year, or b) the annual change in the February-to-February Consumer Price Index for all Urban Consumers, for the West – Size Class B/C area ("CPI"), beginning July 1, 2026. This escalated maximum annual assessment shall be the new maximum annual assessment for that succeeding Fiscal Year and be subject to escalation in every subsequent Fiscal Year.

### **5.3 Data for Annual Assessment Calculations**

Each year, as part of the assessment calculation procedures, the PUD or its designated consultant shall determine the development category for each parcel based on data including, but not limited to, County Assessor's data, PUD's records, GIS data, online research, or other supplementary information made available and deemed reliable.

All parcels categorized as Developable Parcels as of June 1 shall be subject to assessment in the succeeding fiscal year. Should a parcel connect to the PUD's water system after assessment by the Assessment District, the property owner shall be entitled to credit per Section 5.4 below.

### **5.4 Future Changes of a Parcel's Development Status**

Should a Developable Parcel be newly connected to the PUD's water system during a fiscal year for which the assessment has been levied and paid, the property owner shall be entitled to a prorated credit of the monthly amount of the assessment for each full month the property owner has paid both the monthly water meter connection charge and the annual assessment.

Should an Undevelopable Parcel apply for connection to the PUD's water system, it shall not be permitted to do so without paying the catch-up fee described in Section 4.3 Exemptions.

### **5.5 Appeals**

If any property owner believes the data used to calculate the assessment is inaccurate for any reason, the property owner shall submit, in writing, a request for review to the PUD. The property owner shall provide documentation to support the request for review. The PUD or its designated consultant shall review the request and provide a response to the property owner. The property owner must be current in the payment of all assessments when filing the request for review and must remain current during the review process.

If the review conducted by the PUD or its designated consultant results in the approval for changes to any parcel characteristics used to compute the assessment, the PUD or its designated consultant shall recalculate the assessment. When recalculating the assessment, the assessment rates actually applied in such fiscal year shall be used. Only the assessment for the parcel or parcels subject to review shall be recalculated.

If the recalculated assessment for the parcel or parcels being reviewed is less than the amount submitted to the County on the secured property tax roll, the difference shall be credited back to the property owner in a manner approved by the PUD. This credit shall be limited to the current fiscal year and the prior fiscal year, if applicable. The "fiscal year" shall follow the County's fiscal year for property taxes, from July 1 to June 30. The applicable fiscal year shall be determined by the date the request for review is submitted to the PUD.

The credit may be provided in the form of a check issued to the property owner, an adjustment to the current year's property tax roll (if possible), or a credit to the succeeding year's assessment thereby reducing the amount placed on the secured property tax roll for such year.

If the recalculated assessment is greater than the amount submitted to the County on the secured property tax roll, the PUD or its designated consultant shall apply the recalculated assessment to the succeeding year's property tax roll and no adjustments shall be made to the prior or current fiscal years' assessments.

In any dispute over parcel characteristic data used to compute assessments, the PUD or its designated consultant shall make a conclusive determination, and its decision shall be final.

## **5.6 Method of Collection**

The assessments will be collected annually on the Kern County secured property tax roll. The assessments will be subject to the County's assigned due dates and late penalties. However, the PUD or its designated consultant may choose to collect the assessments in an alternate manner (including directly billing the property owner) as may be deemed appropriate or necessary by the PUD or as allowed by law.

## 6. Assessment Diagram

---

The following page(s) contain the assessment diagram for the Assessment District.

# FRAZIER PARK PUBLIC UTILITIES DISTRICT WATER STANDBY CHARGE ASSESSMENT DISTRICT NO. 2025-1

FRAZIER PARK PUBLIC UTILITY DISTRICT  
COUNTY OF KERN  
STATE OF CALIFORNIA

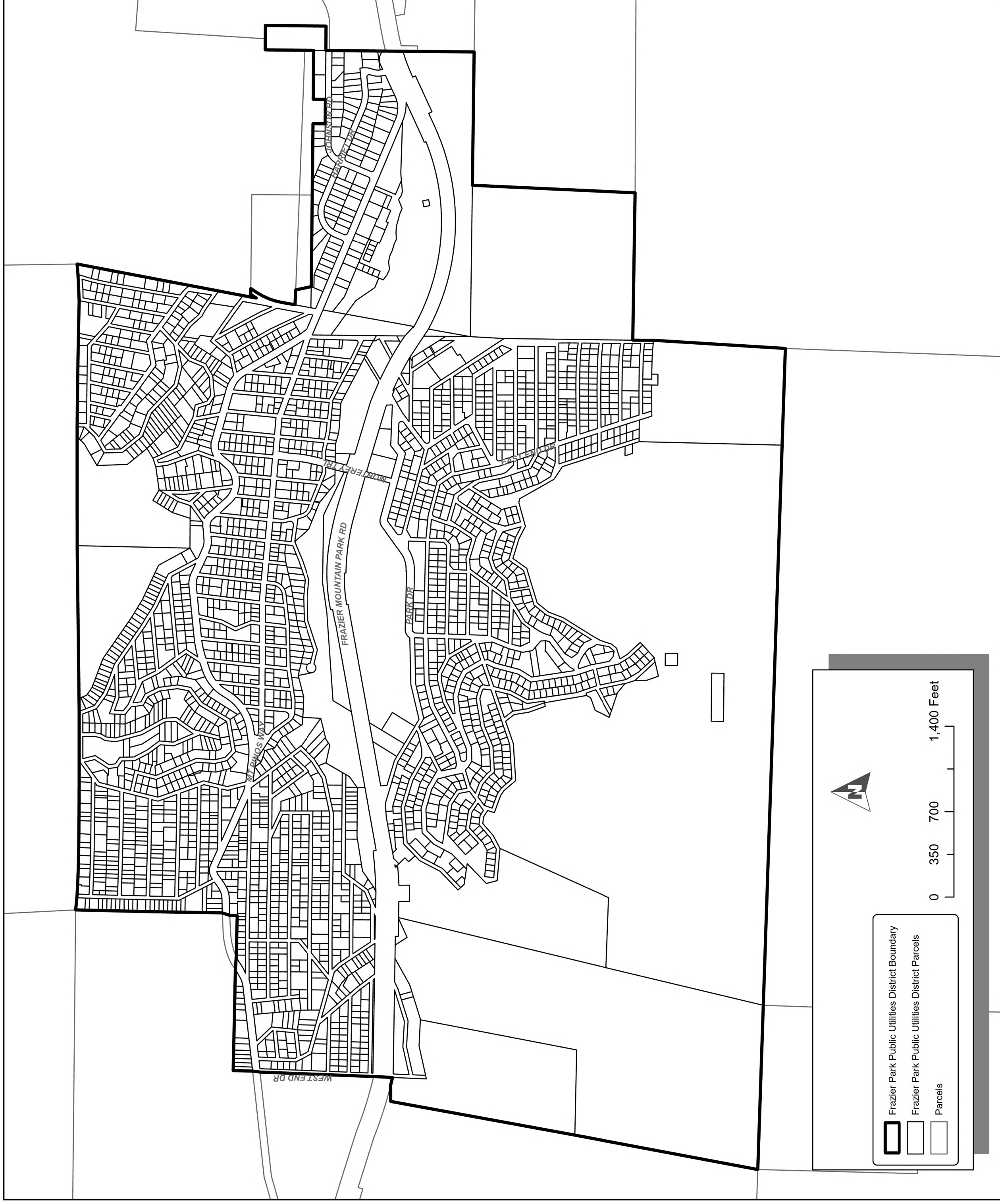

FILED IN THE OFFICE OF THE SECRETARY OF THE BOARD OF THE FRAZIER PARK PUBLIC UTILITIES DISTRICT, COUNTY OF KERN, STATE OF CALIFORNIA, THIS \_\_\_\_ DAY OF \_\_\_\_, 2025.

SECRETARY OF THE BOARD  
FRAZIER PARK PUBLIC UTILITIES DISTRICT  
COUNTY OF KERN, CALIFORNIA

RECORDED IN THE OFFICE OF THE SUPERINTENDENT OF STREETS OF THE FRAZIER PARK PUBLIC UTILITIES DISTRICT ON THE LOTS, PIECES AND PARCELS OF LAND ON THIS ASSESSMENT DIAGRAM ON THE \_\_\_\_ DAY OF \_\_\_\_, 2025.

SECRETARY OF THE BOARD  
FRAZIER PARK PUBLIC UTILITIES DISTRICT  
COUNTY OF KERN, CALIFORNIA

AN ASSESSMENT WAS LEVIED BY THE BOARD OF DIRECTORS OF THE FRAZIER PARK PUBLIC UTILITIES DISTRICT ON THE LOTS, PIECES, AND PARCELS OF LAND SHOWN ON THIS ASSESSMENT DIAGRAM. THE ASSESSMENT WAS LEVIED ON THE \_\_\_\_ DAY OF \_\_\_\_, 2025; THE ASSESSMENT DIAGRAM AND ASSESSMENT ROLL WERE RECORDED IN THE OFFICE OF THE SUPERINTENDENT OF STREETS OF THE FRAZIER PARK PUBLIC UTILITIES DISTRICT ON THE \_\_\_\_ DAY OF \_\_\_\_, 2025. REFERENCE IS MADE TO THE ASSESSMENT ROLL RECORDED IN THE OFFICE OF THE SUPERINTENDENT OF STREETS, FOR THE EXACT AMOUNT OF EACH ASSESSMENT LEVIED AGAINST EACH PARCEL OF LAND SHOWN ON THIS ASSESSMENT DIAGRAM.

SECRETARY OF THE BOARD  
FRAZIER PARK PUBLIC UTILITIES DISTRICT  
COUNTY OF KERN, CALIFORNIA

FILED THIS \_\_\_\_ DAY OF \_\_\_\_, 2025, AT THE HOUR OF \_\_\_\_ O'CLOCK \_\_\_\_ M., IN BOOK \_\_\_\_ OF MAPS OF ASSESSMENT AND COMMUNITY FACILITIES DISTRICTS AT PAGE \_\_\_\_ IN THE OFFICE OF THE COUNTY RECORDER OF THE COUNTY OF KERN, STATE OF CALIFORNIA.

COUNTY RECORDER  
COUNTY OF KERN, CALIFORNIA

FOR PARTICULARS OF THE LINES AND DIMENSIONS OF ASSESSOR PARCELS, REFERENCE IS MADE TO THE MAPS OF THE ASSESSOR, COUNTY OF KERN, STATE OF CALIFORNIA.

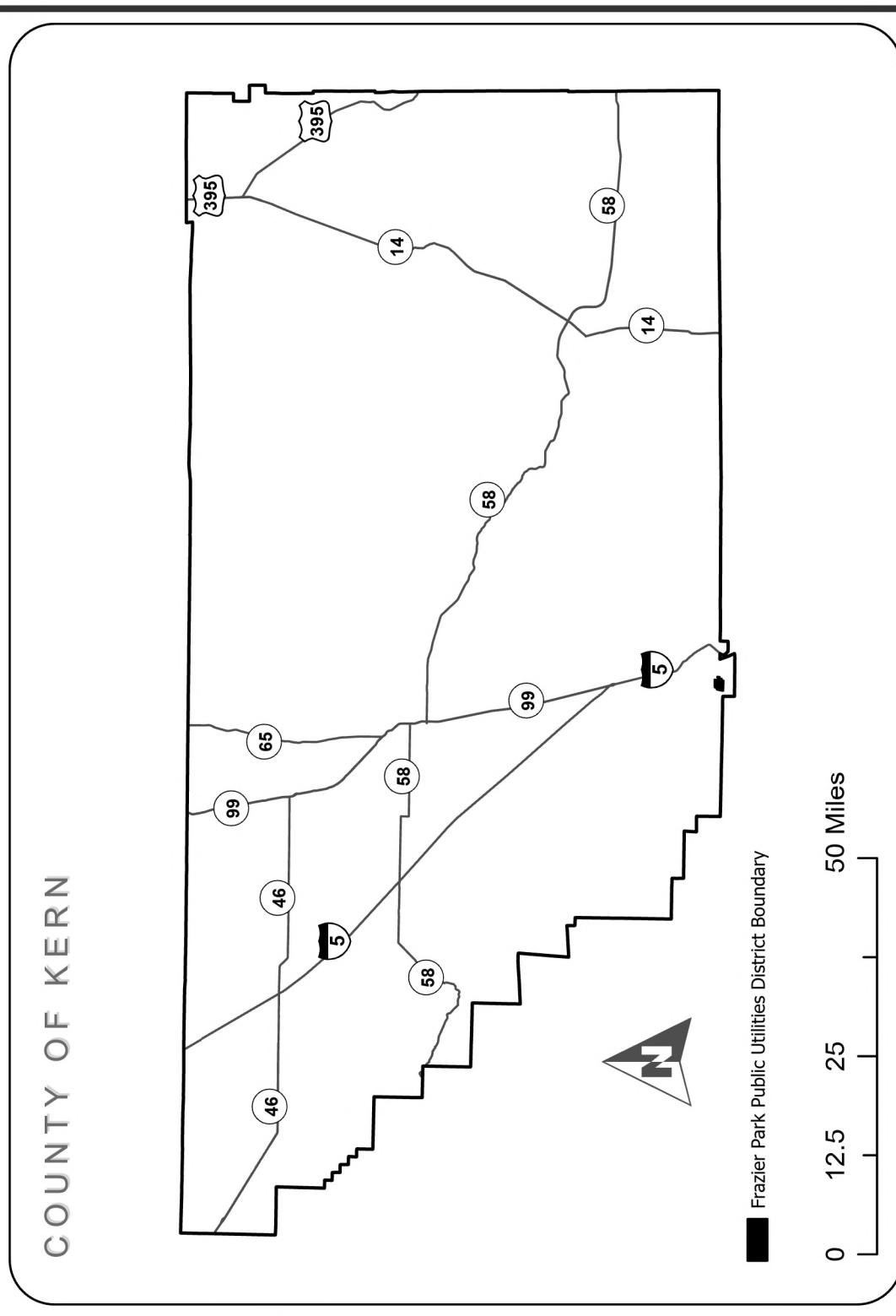

## 7. Assessment Roll

---

The following pages contain the proposed 2025/26 assessment roll for the Assessment District.



Frazier Park Public Utility District  
Water Standby Assessment District No. 2025-1  
Assessment Roll FY 2025/26

<u>Assessor's Parcel Number</u>	<u>Owner Name</u>	<u>Fiscal Year 2025/26 Levy</u>
255-193-35-00-7	LICHTER SIGMUND & ELIZABETH REV TRUST	\$ 96.00
255-320-13-00-9	CARBOYAN KOKO L K & LILIAN	96.00
255-320-14-00-2	PONY EXPRESS ESTS	96.00
255-320-15-00-5	PONY EXPRESS ESTS	96.00
255-320-16-00-8	PONY EXPRESS ESTS	96.00
255-320-17-00-1	PONY EXPRESS ESTS	96.00
255-320-18-00-4	PONY EXPRESS ESTS	96.00
255-320-19-00-7	PONY EXPRESS ESTS	96.00
255-320-20-00-9	PONY EXPRESS ESTS	96.00
255-320-21-00-2	PONY EXPRESS ESTS	96.00
255-320-28-00-3	C&C ELITE PROP LLC	96.00
255-320-38-00-2	PONY EXPRESS ESTS	96.00
255-320-39-00-5	SIMON TRUST	96.00
255-320-40-00-7	SIMON TRUST	96.00
255-332-03-00-7	HUTCHERSON BENJAMIN	96.00
255-332-07-00-9	FRAZIER PARK CAR WASH	96.00
255-333-07-00-6	SODARO LOUIS T FAM TR	96.00
255-333-14-00-6	MOUNT PINOS LLC	96.00
255-334-05-00-7	HART DEVIN & SHIRLEY	96.00
255-334-07-00-3	BAKALYAN AKOP JACK	96.00
255-334-09-00-9	FOWLER BARBARA R	96.00
255-334-12-00-7	CARBOYAN KOKO & LILLIAN	96.00
255-352-10-00-3	MAC INNIS KIRK & MAUREEN LIV TR	96.00
255-353-07-00-2	NGALONGALAY JAMES AUGUST Q & NANCY MELO	96.00
255-353-09-00-8	OWENS JUDYANN WARNER	96.00
255-354-06-00-6	HENNEN THOMAS P & DOROTHY L FAMILY TRUST	96.00
255-361-01-00-3	CARBOYAN KOKO & LILIAN	96.00
256-070-07-00-7	COOPER WILLIAM SCOTT	96.00
259-021-01-00-2	LINDLEY FRED	96.00
259-021-06-00-7	LUTHER JOHN R & BINA W TR	96.00
259-021-13-00-7	LUTHER JOHN R & BINA W TR	96.00
259-021-16-00-6	BECCUE STEPHEN	96.00
259-021-17-00-9	BECCUE STEPHEN	96.00
259-021-20-00-7	LUTHER JOHN R & BINA FAMILY TR	96.00
259-021-21-00-0	LUTHER JOHN R & BONA W	96.00
259-022-47-00-3	DELAMERE MICHAEL & SHROPSHIRE CHRISTY	96.00
259-022-50-00-1	SPARKS ROSS & SHARON E	96.00
259-023-11-00-5	STALL BARBARA E	96.00
259-024-14-00-1	PHILLIPS ROBERT JAMES	96.00
259-024-16-00-7	SANDOVAL ALFREDO	96.00
259-025-12-00-2	BURNHAM JOHN R	96.00
259-025-14-00-8	PROTECTION HOLY VIRGIN THE RUSS ORT CH	96.00

Frazier Park Public Utility District  
 Water Standby Assessment District No. 2025-1  
 Assessment Roll FY 2025/26

<u>Assessor's Parcel Number</u>	<u>Owner Name</u>	<u>Fiscal Year 2025/26 Levy</u>
259-025-15-00-1	GRAVES BRAD D & SUSAN J REVOCABLE TRUST	96.00
259-025-17-00-7	BURNHAM JOHN R & THOMPSON ROBIN	96.00
259-025-20-00-5	KANE FAMILY TRUST	96.00
259-026-01-00-7	JENS JERRY P	96.00
259-026-09-00-1	RETANA ANDREW ANTHONY	96.00
259-027-06-00-9	JENSEN JAMIE	96.00
259-028-06-00-6	CASEBOLT BEN & JULIA	96.00
259-028-07-00-9	CASEBOLT BEN & JULIA	96.00
259-029-11-00-7	JMW & ASSCS NV LLC	96.00
259-029-19-00-1	BARBA GLORIA	96.00
259-029-35-00-7	ARKIE RAYMOND J & ROXANNE J	96.00
259-029-40-00-1	JMW & ASSCS NV LLC	96.00
259-029-41-00-4	JMW & ASSCS NV LLC	96.00
259-029-42-00-7	JMW & ASSCS NV LLC	96.00
259-029-44-00-3	ZURITA ANCELMO FERNANDO GUZMAN	96.00
259-031-16-00-9	WRYE FAMILY TRUST	96.00
259-031-20-00-0	AHN HOKUM & JESSICA E	96.00
259-031-21-00-3	AHN HOKUM & JESSICA E	96.00
259-031-26-00-8	KEENBERG JANICE	96.00
259-032-01-00-2	LEE BOYD & LINDA	96.00
259-032-03-00-8	BROCKMEYER JUSTIN	96.00
259-032-04-00-1	BROCKMEYER JUSTIN	96.00
259-032-06-00-7	HOPEPYAN LEON	96.00
259-032-07-00-0	CALIFORNIA CAPITAL FUND INC	96.00
259-032-08-00-3	CALIFORNIA CAPITAL FUND INC	96.00
259-033-02-00-2	DE MARAH RICHARD H	96.00
259-033-03-00-5	DE MARAH RICHARD H	96.00
259-033-04-00-8	DE MARAH RICHARD H	96.00
259-033-05-00-1	FRIEDL RICK	96.00
259-033-06-00-4	J D LOOMIS INVS LLC	96.00
259-033-07-00-7	ESPITIA ALEJANDRO	96.00
259-033-08-00-0	ESPITIA ALEJANDRO	96.00
259-033-09-00-3	TONG NHIEM & LY HUONG P	96.00
259-033-10-00-5	DONES TINA	96.00
259-033-11-00-8	DONES TINA	96.00
259-033-12-00-1	CLERICO FAMILY TRUST	96.00
259-033-13-00-4	CLERICO FAMILY TRUST	96.00
259-033-14-00-7	CLERICO FAMILY TRUST	96.00
259-033-21-00-7	LUTHER JOHN R & BINA W TR	96.00
259-034-01-00-6	LUTHER FAMILY TR	96.00
259-035-03-00-9	MADDEN MICHAEL J	96.00
259-035-11-00-2	OWENS DAVID B	96.00

Frazier Park Public Utility District  
 Water Standby Assessment District No. 2025-1  
 Assessment Roll FY 2025/26

<u>Assessor's Parcel Number</u>	<u>Owner Name</u>	<u>Fiscal Year 2025/26 Levy</u>
259-036-04-00-9	STROM LINDA SUE	96.00
259-036-05-00-2	ROBREDO LINDA S	96.00
259-036-06-00-5	VIVIRITO MATTHEW	96.00
259-036-08-00-1	3341 LOS PADRES FP	96.00
259-036-10-00-6	DHILLON SIMRANJIT	96.00
259-036-13-00-5	VIVIRITO MATTHEW	96.00
259-036-22-00-1	TYLER BRUCE W & DEBORAH A	96.00
259-036-25-00-0	STROM ROBREDO LINDA	96.00
259-036-27-00-6	ARGUL MARIA VICTORIA	96.00
259-036-28-00-9	RICHARDSON LOUETTA G	96.00
259-042-04-00-4	THOMPSON JAY P & JUDY ANN	96.00
259-042-05-00-7	COX WALLACE W	96.00
259-042-06-00-0	PLANTIER DAVID R TRUST	96.00
259-043-09-00-6	BETTIS DAVID C SR & DONNA R	96.00
259-043-10-00-8	STUDER CLAUDIA	96.00
259-043-13-00-7	HOFMAN FAMILY TRUST	96.00
259-044-02-00-2	MULLER ROLAND ARTHUR	96.00
259-044-03-00-5	MULLER ROLAND ARTHUR	96.00
259-044-04-00-8	MULLER ROLAND ARTHUR	96.00
259-044-05-00-1	MULLER ROLAND ARTHUR	96.00
259-044-06-00-4	MULLER ROLAND ARTHUR	96.00
259-044-07-00-7	MULLER ROLAND ARTHUR	96.00
259-044-08-00-0	MULLER ROLAND ARTHUR	96.00
259-044-09-00-3	MULLER ROLAND ARTHUR	96.00
259-044-10-00-5	AEK GLOBAL INVS LLC	96.00
259-044-11-00-8	MULLER ROLAND ARTHUR	96.00
259-044-18-00-9	LEE BOYD & LINDA	96.00
259-044-21-00-7	CALIFORNIA CAPITAL FUND INC	96.00
259-044-23-00-3	POTES ROBBIN BRUCE	96.00
259-044-24-00-6	POTES ROBBIN BRUCE	96.00
259-044-25-00-9	AEK GLOBAL INVS LLC	96.00
259-044-27-00-5	ESTLE GAY D REV TR	96.00
259-044-28-00-8	CARVER ANGEL	96.00
259-044-29-00-1	POTES ROBBIN BRUCE	96.00
259-044-36-00-1	ZIGLER IRENE	96.00
259-045-01-00-6	SCHNEIDER FAMILY TRUST	96.00
259-045-03-00-2	CLERICO FAMILY TRUST	96.00
259-045-04-00-5	ANDREEV ALEXEY ANATOLYEVICH	96.00
259-046-01-00-3	SILVA JULIO	96.00
259-046-13-00-8	WRIGHT CINDERELLA B	96.00
259-046-19-00-6	JOHNSON KENT	96.00
259-051-04-00-0	KOKHANOVSKI ELENA	96.00

Frazier Park Public Utility District  
 Water Standby Assessment District No. 2025-1  
 Assessment Roll FY 2025/26

<u>Assessor's Parcel Number</u>	<u>Owner Name</u>	<u>Fiscal Year 2025/26 Levy</u>
259-051-07-00-9	PADILLA JUAN ET AL	96.00
259-051-12-00-3	CARBOYAN KOKO & CARBOYAN LILLAN	96.00
259-051-13-00-6	CARBOYAN KOKO & LILIAN	96.00
259-051-14-00-9	CARBOYAN KOKO & LILIAN	96.00
259-051-17-00-8	CARBOYAN KOKO & LILIAN	96.00
259-051-18-00-1	CARBOYAN KOKO & LILIAN	96.00
259-051-19-00-4	FIORELLO JOSE & MARY JANE SAN DIEGO TRUST	96.00
259-051-20-00-6	MARRACCINO TRUST	96.00
259-051-21-00-9	RAMIREZ DIANA ELIZABETH	96.00
259-052-01-00-8	YOUNGQUIST RAYMOND C & ALICE TR	96.00
259-053-13-00-0	TASHNEK FAMILY TRUST	96.00
259-054-01-00-2	SOBEL WILLIAM ALAN	96.00
259-054-02-00-5	SOBEL WILLIAM ALAN	96.00
259-054-03-00-8	SOBEL WILLIAM ALAN	96.00
259-054-04-00-1	SOBEL WILLIAM ALAN	96.00
259-054-05-00-4	SOBEL WILLIAM ALAN	96.00
259-054-06-00-7	KARAGHOSSIAN BERGE G & ANTONYAN ANAIT	96.00
259-054-07-00-0	BOUFFARD LINDA REV TR	96.00
259-054-10-00-8	BAILEY LARRY H TRUST	96.00
259-054-11-00-1	BOUFFARD LINDA REV TR	96.00
259-061-02-00-7	BROSHEARS RANDOLPH S TR	96.00
259-061-06-00-9	HAMBER ROBERT A & KREGEL MARY E	96.00
259-061-07-00-2	HAMBER ROBERT A & KREGEL MARY E	96.00
259-061-08-00-5	HAMBER ROBERT A & KREGEL MARY E	96.00
259-061-09-00-8	HAMBER ROBERT A & KREGEL MARY E	96.00
259-061-10-00-0	HAMBER ROBERT A & KREGEL MARY E	96.00
259-061-11-00-3	CLERICO FAMILY TRUST	96.00
259-061-12-00-6	CLERICO FAMILY TRUST	96.00
259-061-13-00-9	CLERICO FAMILY TRUST	96.00
259-061-15-00-5	DAFFY ANDREW JONATHAN	96.00
259-061-16-00-8	DAFFY ANDREW JONATHAN	96.00
259-061-18-00-4	MANSTON GREGG	96.00
259-061-19-00-7	MANTOR SHAWN P	96.00
259-061-20-00-9	MANTOR SHAWN P	96.00
259-061-21-00-2	ALFARO JAIME & ALMA	96.00
259-061-22-00-5	ALFARO JAIME & ALMA	96.00
259-061-23-00-8	ALFARO JAIME & ALMA	96.00
259-061-24-00-1	SEARCY FANNY	96.00
259-061-25-00-4	SEARCY FANNY	96.00
259-061-26-00-7	SEARCY FANNY	96.00
259-061-27-00-0	MARRACCINO TRUST	96.00
259-061-28-00-3	MARRACCINO TRUST	96.00

Frazier Park Public Utility District  
 Water Standby Assessment District No. 2025-1  
 Assessment Roll FY 2025/26

<u>Assessor's Parcel Number</u>	<u>Owner Name</u>	<u>Fiscal Year 2025/26 Levy</u>
259-061-29-00-6	MARRACCINO TRUST	96.00
259-061-30-00-8	MC KIM LOU VON	96.00
259-061-31-00-1	MC KIM LOU VON	96.00
259-061-32-00-4	ARAGON FAMILY TR	96.00
259-061-33-00-7	ARAGON FAMILY TR	96.00
259-061-34-00-0	DUFFY MAUREEN FAMILY TRUST	96.00
259-061-35-00-3	DUFFY MAUREEN M TRUST	96.00
259-061-36-00-6	GINWALA CASSIM I	96.00
259-061-37-00-9	GINWALA CASSIM I	96.00
259-061-40-00-7	JOHNSON RICK D & LORI FAMILY TRUST	96.00
259-062-01-00-1	MARQUEZ STEVEN G & RENEE GALIPO	96.00
259-062-04-00-0	CHORPASH RENEE C	96.00
259-062-06-00-6	DE LEON RODRIGO Y & BERRERA DE LEON SANDRA	96.00
259-062-11-00-0	CANYON PROPERTIES LLC	96.00
259-062-12-00-3	MARQUEZ STEVEN G & RENEE ANN	96.00
259-062-13-00-6	CANYON PROPERTIES LLC	96.00
259-062-14-00-9	CANYON PROPERTIES LLC	96.00
259-063-04-00-7	HART DEVIN	96.00
259-063-07-00-6	CERVANTES SALVADOR & MARTHA FAMILY TRUST	96.00
259-063-14-00-6	NORMAN FAMILY TRUST	96.00
259-064-02-00-8	CAVEY JOHN L	96.00
259-064-05-00-7	JOHNSON FAMILY BYPASS TR	96.00
259-064-06-00-0	JOHNSON FAMILY BYPASS TR	96.00
259-064-12-00-7	NELSON KEITH H & CATHERINE J TR	96.00
259-064-13-00-0	NELSON KEITH H & CATHERINE J TR	96.00
259-065-02-00-5	LA CHAUSSE KATE	96.00
259-065-06-00-7	IVES ROBERT S JR & JODI TR	96.00
259-065-09-00-6	INGRAM TRUST	96.00
259-065-10-00-8	HANLIN DANIEL H	96.00
259-065-11-00-1	MIYAMOTO DIANE C DOTY	96.00
259-065-14-00-0	WILCOX SHAUNA	96.00
259-065-22-00-3	SPYRKA LAURA E	96.00
259-065-26-00-5	SHROPSHIRE MARTHA	96.00
259-065-27-00-8	WATKINSON DAVID & ELAINE	96.00
259-072-04-00-3	PORTER TRUST	96.00
259-072-07-00-2	IMAN SANDRA LEA	96.00
259-072-10-00-0	VITERI MARKO	96.00
259-072-11-00-3	IMAN SANDRA LEA	96.00
259-072-12-00-6	IMAN SANDRA LEA	96.00
259-072-13-00-9	ULRICH GARRY A	96.00
259-072-14-00-2	PORTER TRUST	96.00
259-072-15-00-5	IMAN SANDRA LEA	96.00

Frazier Park Public Utility District  
 Water Standby Assessment District No. 2025-1  
 Assessment Roll FY 2025/26

<u>Assessor's Parcel Number</u>	<u>Owner Name</u>	<u>Fiscal Year 2025/26 Levy</u>
259-072-17-00-1	NAGUIT JONATHAN	96.00
259-072-18-00-4	NAGUIT JONATHAN	96.00
259-072-19-00-7	FLICKINGER HELEN	96.00
259-072-20-00-9	PALACIOS FRANKLIN & ERIKA	96.00
259-073-02-00-4	DYKMAN WILLIAM E & SHERYL A	96.00
259-073-03-00-7	DYKMAN WILLIAM E & SHERYL A	96.00
259-073-04-00-0	DYKMAN WILLIAM E & SHERYL A	96.00
259-074-01-00-8	PETROSYAN ANAHIT	96.00
259-074-02-00-1	PETROSYAN ANAHIT	96.00
259-074-03-00-4	GREENHORN VALLEY LAND LLC	96.00
259-074-04-00-7	ALTMAN BARBARA C	96.00
259-074-06-00-3	ROKSTAD MARISA	96.00
259-074-07-00-6	ROKSTAD MARISA	96.00
259-074-08-00-9	ROKSTAD MARISA	96.00
259-074-09-00-2	ROKSTAD MARISA	96.00
259-074-10-00-4	VAN BRAD & BURT	96.00
259-074-11-00-7	VAN BRAD & BURT	96.00
259-074-12-00-0	VAN BRAD & BURT	96.00
259-074-13-00-3	VAN BRAD & BURT	96.00
259-074-14-00-6	VAN BRAD & BURT	96.00
259-074-15-00-9	VAN BRAD & BURT	96.00
259-074-16-00-2	VAN BRAD & BURT	96.00
259-074-17-00-5	VAN BRAD & BURT	96.00
259-074-18-00-8	VAN BRAD & BURT	96.00
259-074-20-00-3	SELLZ GREGORY SCOTT	96.00
259-074-21-00-6	SELLZ GREGORY SCOTT	96.00
259-074-22-00-9	DELZER THERESA TRUST	96.00
259-074-23-00-2	DELZER THERESA TRUST	96.00
259-074-25-00-8	BROWN DOUGLAS	96.00
259-074-26-00-1	ALTMAN BARBARA C TRS	96.00
259-074-28-00-7	PETROSYAN ANAHIT	96.00
259-074-29-00-0	PETROSYAN ANAHIT	96.00
259-074-30-00-2	PETROSYAN ANAHIT	96.00
259-074-31-00-5	HERRERA EDMUNDO JAVIER	96.00
259-075-03-00-1	WAHLER DONALD LIV TR	96.00
259-075-05-00-7	WHITE RALPH B	96.00
259-081-02-00-3	DYKMAN WILLIAM E & SHERYL A	96.00
259-081-03-00-6	DYKMAN WILLIAM E & SHERYL A	96.00
259-081-04-00-9	DYKMAN WILLIAM E & SHERYL A	96.00
259-081-05-00-2	DYKMAN WILLIAM E & SHERYL A	96.00
259-082-04-00-6	GIRLING ROBERT & SHERRY KEITH TRUST	96.00
259-082-05-00-9	BAKER LIVING TRUST	96.00

Frazier Park Public Utility District  
Water Standby Assessment District No. 2025-1  
Assessment Roll FY 2025/26

<u>Assessor's Parcel Number</u>	<u>Owner Name</u>	<u>Fiscal Year 2025/26 Levy</u>
259-082-07-00-5	MIRIJANIAN ARDASHES	96.00
259-082-08-00-8	MIRIJANIAN ARDASHES	96.00
259-082-10-00-3	MIRIJANIAN ARDASHES	96.00
259-082-13-00-2	WHEATON JOANNE M	96.00
259-082-15-00-8	DILL JOHN B & SHELLEY M	96.00
259-082-17-00-4	DILL JOHN B & SHELLEY M	96.00
259-082-18-00-7	PETROSYAN ANAHIT	96.00
259-082-19-00-0	PETROSYAN ANAHIT	96.00
259-082-21-00-5	PETROSYAN ANAHIT	96.00
259-082-22-00-8	PETROSYAN ANAHIT	96.00
259-082-23-00-1	NEXT GENERATION TRUST	96.00
259-082-24-00-4	DILL JOHN BRIAN & SHELLEY MARIE	96.00
259-082-25-00-7	DILL JOHN BRIAN & SHELLEY MARIE	96.00
259-082-27-00-3	CHEMALY PIERRE J	96.00
259-082-29-00-9	CHEMALY PIERRE J	96.00
259-082-31-00-4	BAKER LIVING TRUST	96.00
259-082-32-00-7	BAKER LIVING TRUST	96.00
259-082-34-00-3	PALACIOS FRANKLIN & ERIKA	96.00
259-082-36-00-9	PERRY MICHAEL P	96.00
259-082-39-00-8	FESSIA JODY L	96.00
259-082-40-00-0	PARKER CHAD T	96.00
259-082-41-00-3	DILL JOHN BRIAN & SHELLEY MARIE	96.00
259-082-42-00-6	KURTZ MICHAEL	96.00
259-084-02-00-4	RANDALLS RYAN L	96.00
259-084-07-00-9	WOERTER LAWERANCE R & BELINDA	96.00
259-084-15-00-2	RYAN YONG S TR	96.00
259-084-17-00-8	PRIDGIN HAROLD DEAN	96.00
259-084-20-00-6	PERIALE PAMELA & JOHN	96.00
259-084-26-00-4	KARAGHOSSIAN BERGE G & ANTONYAN ANAIT	96.00
259-084-30-00-5	PRIDGIN HAROLD DEAN	96.00
259-084-32-00-1	HUANG SHUWEI	96.00
259-084-33-00-4	SOBEL WILLIAM NON PROTOTYPE PENSION PLAN	96.00
259-084-34-00-7	CANYON PROPERTIES LLC	96.00
259-084-38-00-9	PERIALE PAMELA & JOHN	96.00
259-084-40-00-4	PERIALE PAMELA & JOHN	96.00
259-085-01-00-8	FINCH STEVEN & ALLAN & MICHAEL ET AL	96.00
259-085-02-00-1	FINCH STEVEN & ALLAN & MICHAEL ET AL	96.00
259-085-04-00-7	SCHNEIDER GEORGE W & HANNA E	96.00
259-085-05-00-0	SCHNEIDER GEORGE W & HANNA E	96.00
259-085-06-00-3	SCHNEIDER GEORGE W & HANNA E	96.00
259-085-07-00-6	SCHNEIDER GEORGE W & HANNA E	96.00
259-085-08-00-9	SCHNEIDER GEORGE W & HANNA E	96.00

Frazier Park Public Utility District  
 Water Standby Assessment District No. 2025-1  
 Assessment Roll FY 2025/26

<u>Assessor's Parcel Number</u>	<u>Owner Name</u>	<u>Fiscal Year 2025/26 Levy</u>
259-085-09-00-2	SCHNEIDER GEORGE W & HANNA E	96.00
259-085-10-00-4	SCHNEIDER GEORGE W & HANNA E	96.00
259-085-11-00-7	SCHNEIDER GEORGE W & HANNA E	96.00
259-085-14-00-6	PERRELL ANTOINETTE C	96.00
259-085-15-00-9	DILL JOHN & SHELLEY MARIE	96.00
259-085-16-00-2	FINCH ALLAN & STEVEN	96.00
259-085-17-00-5	FINCH ALLAN & STEVEN	96.00
259-085-18-00-8	ORRIN FAMILY TRUST	96.00
259-085-19-00-1	ORRIN FAMILY TRUST	96.00
259-085-21-00-6	SEARCY TRUST	96.00
259-085-23-00-2	JEFFRIES FAMILY TRUST	96.00
259-085-25-00-8	POGHOSYAN HRANT	96.00
259-085-26-00-1	POGHOSYAN HRANT	96.00
259-085-28-00-7	POGHOSYAN HRANT	96.00
259-085-29-00-0	POGHOSYAN HRANT	96.00
259-090-06-00-1	LIFESTYLE FRAZIER PARK RE LLC	96.00
259-111-01-00-8	COPPER MICHAEL G	96.00
259-111-02-00-1	COPPER MICHAEL	96.00
259-111-06-00-3	MC DONALD PATRICIA	96.00
259-111-07-00-6	MC DONALD PATRICIA	96.00
259-111-09-00-2	LEONIS ROBERT D & COSKO DIANA T	96.00
259-111-10-00-4	SCHOENBERG LISA H	96.00
259-112-04-00-4	WHEATON JOANNE M	96.00
259-112-10-00-1	SAPIEN JOSEPH & ANTHONY ET AL	96.00
259-112-11-00-4	BRUNNENGRABER FAM TRUST B	96.00
259-112-18-00-5	KLEIDER NANCY ANNE & SHAUN MICHAEL	96.00
259-112-26-00-8	BAUER ELIZABETH A TRUST	96.00
259-112-27-00-1	MILACK KAREN A & RICHARD G	96.00
259-113-01-00-2	GAINES DANIEL ANTHONY & TOYAMA GAINES RIKA	96.00
259-113-02-00-5	GAINES DANIEL ANTHONY & TOYAMA GAINES RIKA	96.00
259-113-04-00-1	MORALES ENRIQUE	96.00
259-113-07-00-0	REICHERT MARITA	96.00
259-113-08-00-3	REICHERT MARITA	96.00
259-113-09-00-6	REICHERT MARITA	96.00
259-113-13-00-7	BRUSCA JOSEPH L & AMY M	96.00
259-113-14-00-0	BRUSCA JOSEPH L & AMY M	96.00
259-113-18-00-2	LUCKETT DALE & ROBERTSON DIA	96.00
259-113-21-00-0	STEPHENSON PAUL E & SHERRY	96.00
259-113-22-00-3	REZNIKOV YURIY	96.00
259-113-24-00-9	MACE LLEWELLYN E & KATHLEEN D	96.00
259-113-37-00-7	LUCKETT DALE & ROBERTSON DIA	96.00
259-113-43-00-4	RANGEL SONIA	96.00



Frazier Park Public Utility District  
 Water Standby Assessment District No. 2025-1  
 Assessment Roll FY 2025/26

<u>Assessor's Parcel Number</u>	<u>Owner Name</u>	<u>Fiscal Year 2025/26 Levy</u>
259-113-45-00-0	MORALES ENRIQUE	96.00
259-113-46-00-3	MORALES ENRIQUE	96.00
259-113-47-00-6	MORALES ENRIQUE	96.00
259-114-02-00-2	GOMEZ MICHAEL & CHRISTINA	96.00
259-114-04-00-8	GOMEZ MICHAEL & CHRISTINA	96.00
259-114-08-00-0	SANTOS TERESA ZERAPIO	96.00
259-114-10-00-5	REED DAVID	96.00
259-114-11-00-8	REED DAVID	96.00
259-114-14-00-7	STARK FRANK & BARBARA	96.00
259-114-17-00-6	JOLLEY TR	96.00
259-114-24-00-6	GAMBLE WILLIAM	96.00
259-114-26-00-2	TURNER DENNIS M & DEBORAH A	96.00
259-114-28-00-8	MAC INNIS KIRK & MAUREEN	96.00
259-114-32-00-9	KENNEDY BART H SR	96.00
259-114-35-00-8	STARK FRANK & BARBARA	96.00
259-121-07-00-9	SOLARES GERSI	96.00
259-121-14-00-9	NAZARIAN JULIET	96.00
259-121-15-00-2	BABAKHANLOO ARMI	96.00
259-121-16-00-5	GONZALEZ ANTONIO M	96.00
259-121-18-00-1	KURGES FMLY TR	96.00
259-121-19-00-4	YARLAGADDA ACHANTA REV LIV TR	96.00
259-121-20-00-6	JESME HOWARD II	96.00
259-122-03-00-4	GONZALEZ MABEL	96.00
259-122-04-00-7	ROSANDER GENE & BETSY LEE	96.00
259-122-06-00-3	GARCIA ESTEBAN DAMIAN	96.00
259-122-08-00-9	MILLER R W & P L REV TRUST	96.00
259-122-16-00-2	MACLAREN ESTHER M LIVING TRUST	96.00
259-122-19-00-1	ROY EDWARD A	96.00
259-122-45-00-6	VANN MICHAEL W	96.00
259-123-10-00-1	WISCH FAM TR	96.00
259-123-11-00-4	WISCH FAM TR	96.00
259-123-18-00-5	F P PROPERTIES	96.00
259-123-19-00-8	OMAN MICHAEL & HEATHER	96.00
259-124-05-00-4	DJURKOWITSCH GEORGE	96.00
259-124-07-00-0	DUBOIS DAVID ARTHUR & TRACIE	96.00
259-124-12-00-4	BARNETT REBA J	96.00
259-124-15-00-3	RUBIO JOSE L & MARIA CONSUELO	96.00
259-124-16-00-6	RUBIO JOSE L & MARIA CONSUELO	96.00
259-124-17-00-9	DUBOIS DAVID & TRACIE	96.00
259-124-18-00-2	DUBOIS DAVID & TRACIE	96.00
259-124-27-00-8	DJURKOWITSCH GEORGE	96.00
259-124-30-00-6	WHITE NICOLETTE K	96.00

Frazier Park Public Utility District  
 Water Standby Assessment District No. 2025-1  
 Assessment Roll FY 2025/26

<u>Assessor's Parcel Number</u>	<u>Owner Name</u>	<u>Fiscal Year 2025/26 Levy</u>
259-124-37-00-7	WHITE FAMILY TR	96.00
259-124-39-00-3	CARROLL SUE SONDRRA REVOCABLE TRUST	96.00
259-124-42-00-1	WHITE FAMILY TR	96.00
259-125-08-00-0	MURPHY MICHAEL & SUSAN LIVING TRUST	96.00
259-141-02-00-0	DAOUST ROBERT	96.00
259-141-07-00-5	DJUKIC TONA TRUST	96.00
259-142-02-00-7	SJOBORG JAMES ALAN TRUST	96.00
259-142-03-00-0	LIFESTYLE FRAZIER PARK RE LLC	96.00
259-142-05-00-6	COLEMAN ALYCE GAY TRUST	96.00
259-142-07-00-2	COLEMAN ALYCE GAY TRUST	96.00
259-142-08-00-5	LIFESTYLE FRAZIER PARK RE LLC	96.00
259-142-09-00-8	LIFESTYLE FRAZIER PARK RE LLC	96.00
259-143-02-00-4	DALESSIO ROBERT F	96.00
259-143-05-00-3	LICHTER SIGMUND & ELIZABETH REVOCABLE TRUST	96.00
259-143-06-00-6	HASKINS ROSCOE R	96.00
259-143-07-00-9	LICHTER SIGMUND & ELIZABETH REVOCABLE TRUST	96.00
259-143-08-00-2	LICHTER SIGMUND & ELIZABETH REVOCABLE TRUST	96.00
259-143-09-00-5	LICHTER SIGMUND & ELIZABETH REVOCABLE TRUST	96.00
259-143-10-00-7	LICHTER SIGMUND & ELIZABETH REVOCABLE TRUST	96.00
259-143-11-00-0	LICHTER SIGMUND & ELIZABETH REVOCABLE TRUST	96.00
259-143-14-00-9	DALESSIO ROBERT F	96.00
259-143-15-00-2	LICHTER SIGMUND & ELIZABETH REVOCABLE TRUST	96.00
259-144-01-00-8	LIFESTYLE FRAZIER PARK RE LLC	96.00
259-144-02-00-1	LIFESTYLE FRAZIER PARK RE LLC	96.00
259-144-03-00-4	LIFESTYLE FRAZIER PARK RE LLC	96.00
259-144-04-00-7	ASPEN FINANCIAL CORP	96.00
259-144-05-00-0	ASPEN FINANCIAL CORP	96.00
259-144-06-00-3	ASPEN FINANCIAL CORP	96.00
259-144-07-00-6	ASPEN FINANCIAL CORP	96.00
259-144-08-00-9	MILACK RICHARD G & KAREN A	96.00
259-144-09-00-2	HESSEL MICHAEL & KAREN	96.00
259-144-10-00-4	HESSEL MICHAEL & KAREN	96.00
259-144-11-00-7	HESSEL MICHAEL & KAREN	96.00
259-144-12-00-0	HESSEL MICHAEL & KAREN	96.00
259-144-13-00-3	HESSEL MICHAEL & KAREN	96.00
259-145-01-00-5	MARTINEZ CANDIDO ROJAS	96.00
259-145-03-00-1	MARTINEZ CANDIDO ROJAS	96.00
259-145-04-00-4	NICHOLS SUSAN LOUISE	96.00
259-145-07-00-3	MILACK RICHARD G & KAREN	96.00
259-145-08-00-6	HESSEL KYLE & ANASTASIA	96.00
259-145-11-00-4	NICHOLS SUSAN LOUISE	96.00
259-145-12-00-7	MARTINEZ CANDIDO ROJAS	96.00

Frazier Park Public Utility District  
Water Standby Assessment District No. 2025-1  
Assessment Roll FY 2025/26

<u>Assessor's Parcel Number</u>	<u>Owner Name</u>	<u>Fiscal Year 2025/26 Levy</u>
259-146-02-00-5	CARBOYAN KOKO & LILIAN	96.00
259-146-03-00-8	WEBBER JUSTIN	96.00
259-146-04-00-1	WEBBER JUSTIN	96.00
259-146-05-00-4	PRICE DISPOSAL INC	96.00
259-146-06-00-7	PRICE DISPOSAL INC	96.00
259-146-07-00-0	PRICE ENVIRONMENTAL SERV LLC	96.00
259-146-09-00-6	VER BURG JOEL & KARINA	96.00
259-146-12-00-4	CARBOYAN KOKO & LILIAN	96.00
259-146-13-00-7	CARBOYAN KOKO & LILIAN	96.00
259-146-17-00-9	CARBOYAN KOKO & LILIAN	96.00
259-147-02-00-2	FRAZIER PARK VINEYARD CHRISTIAN FELLOWSHIP	96.00
259-147-03-00-5	RUFF MICHAEL	96.00
259-147-04-00-8	AKARI RASEM A LIV TR	96.00
259-147-07-00-7	FRAZIER PARK VINEYARD CHRISTIAN FELLOWSHIP	96.00
259-147-12-00-1	AKARI RASEM A LIV TR	96.00
259-147-13-00-4	AKARI RASEM A LIV TR	96.00
259-148-01-00-6	FRAZIER PARK VINEYARD CHRISTIAN FELLOWSHIP	96.00
259-148-03-00-2	LEINEN NICHOLAS & KATHLEEN FMLY TR	96.00
259-148-07-00-4	HAMBARDZUMYAN ARMAN	96.00
259-148-14-00-4	FRAZIER PARK VINEYARD CHRISTIAN FELLOWSHIP	96.00
259-148-15-00-7	LEINEN NICHOLAS & KATHLEEN FMLY TR	96.00
259-148-19-00-9	DE GOUGH JIM & DONNA	96.00
259-148-20-00-1	BEALE MARCUS	96.00
259-148-22-00-7	BAL CARREIR INC	96.00
259-151-09-00-4	WICAB OMAR & ERRINGTON MALLERY FAMILY TRUST	96.00
259-151-11-00-9	KERNS MICHAEL	96.00
259-152-02-00-0	BULUSU VISHWANATH	96.00
259-152-08-00-8	LO GUERICO EUGENE & DEBRA J	96.00
259-152-10-00-3	HESEL MICHAEL & KAREN	96.00
259-153-02-00-7	THORBURN DOUG	96.00
259-153-04-00-3	KHALIL SAMEER F	96.00
259-153-05-00-6	KHALIL MANHAL & ROUAA TR	96.00
259-153-07-00-2	KHALIL SAMEER F & ENSAT LIV TR	96.00
259-153-08-00-5	KHALIL SAMEER F & ENSAT LIV TR	96.00
259-153-09-00-8	KHALIL SAMEER F & ENSAT LIV TR	96.00
259-153-12-00-6	KHALIL MANHAL & ROUAA TR	96.00
259-153-13-00-9	KHALIL MANHAL & ROUAA TR	96.00
259-153-14-00-2	KHALIL MANHAL & ROUAA TR	96.00
259-153-15-00-5	KHALIL SAMEER F	96.00
259-153-16-00-8	KHALIL SAMEER F	96.00
259-154-02-00-4	LICHTER SIGMUND & ELIZABETH REV TRUST	96.00
259-154-05-00-3	WAINRIGHT TR	96.00

Frazier Park Public Utility District  
 Water Standby Assessment District No. 2025-1  
 Assessment Roll FY 2025/26

<u>Assessor's Parcel Number</u>	<u>Owner Name</u>	<u>Fiscal Year 2025/26 Levy</u>
259-154-06-00-6	WAINRIGHT TR	96.00
259-154-07-00-9	WAINRIGHT TR	96.00
259-154-10-00-7	WAINRIGHT TR	96.00
259-155-03-00-4	SANDIFER EMILY	96.00
259-155-04-00-7	WAINRIGHT TR	96.00
259-156-06-00-0	MILACK RICHARD & KAREN	96.00
259-156-08-00-6	ALPINE PLAZA LLC	96.00
259-156-10-00-1	MILACK RICHARD & KAREN	96.00
259-157-02-00-5	LICHTER SIGMUND & ELIZABETH REVOCABLE TRUST	96.00
259-157-03-00-8	IRVING JON LEE & ANNA MARIA GARNICA	96.00
259-157-05-00-4	LICHTER SIGMUND & ELIZABETH REV TRUST	96.00
259-157-08-00-3	LICHTER SIGMUND & ELIZABETH REV TRUST	96.00
259-158-02-00-2	DURSO FRANK & MILLS BRIGITTE	96.00
259-158-04-00-8	DUNLAP STEVEN M	96.00
259-158-07-00-7	DUNLAP STEVEN M	96.00
259-159-04-00-5	GRAND PINE TRUST	96.00
259-159-07-00-4	PROPP JASON	96.00
259-159-08-00-7	PROPP JASON	96.00
259-159-11-00-5	KHALIL SAMEER FADEL	96.00
259-159-12-00-8	MILACK RICHARD & KAREN	96.00
259-159-13-00-1	MILACK RICHARD & KAREN	96.00
259-159-14-00-4	MILACK RICHARD & KAREN	96.00
259-159-17-00-3	TRUMBLE RAYMOND	96.00
259-161-06-00-8	GANSON SCOTT & SIRIMA	96.00
259-161-10-00-9	REID MARK M & STEPHANIE L	96.00
259-161-11-00-2	AVERY NICHOLAS RICHARD	96.00
259-162-01-00-0	RUSSELL KIMBERLIE A LAND TRUST	96.00
259-162-02-00-3	RUSSELL KIMBERLIE A LAND TRUST	96.00
259-162-04-00-9	RUSSELL KIMBERLIE A LAND TRUST	96.00
259-162-05-00-2	AGUINALDO FERDINAND L	96.00
259-163-04-00-6	AGUINALDO FERDINAND	96.00
259-164-01-00-4	RUSSELL KIMBERLIE A LAND TRUST	96.00
259-164-02-00-7	RUSSELL KIMBERLIE A LAND TRUST	96.00
259-164-03-00-0	MARRACCINO TR	96.00
259-164-05-00-6	WATERHOUSE FREDRICK	96.00
259-165-02-00-4	MIYAMOTO DIANE C DOTY	96.00
259-165-03-00-7	MIYAMOTO DIANE C DOTY	96.00
259-165-04-00-0	MIYAMOTO DIANE C DOTY	96.00
259-165-07-00-9	BLUE PACIFIC HOLDING INC	96.00
259-165-09-00-5	GALVAN ALEX	96.00
259-165-10-00-7	JENSEN RONALD & EDA	96.00
259-165-11-00-0	JENSEN RONALD & EDA	96.00

Frazier Park Public Utility District  
 Water Standby Assessment District No. 2025-1  
 Assessment Roll FY 2025/26

<u>Assessor's Parcel Number</u>	<u>Owner Name</u>	<u>Fiscal Year 2025/26 Levy</u>
259-165-15-00-2	KEENBERG JANICE H	96.00
259-166-09-00-2	BLACKSTOCK DAVID S	96.00
259-166-10-00-4	BLACKSTOCK DAVID S	96.00
259-166-11-00-7	BLACKSTOCK DAVID S	96.00
259-166-18-00-8	GOODRICH JAMES D	96.00
259-167-09-00-9	JENSEN CURTIS ARLO LIVING TRUST	96.00
259-167-10-00-1	MC PARTLIN RANDI JO & BEALL JUSTIN	96.00
259-167-11-00-4	MC PARTLIN RANDI JO & BEALL JUSTIN	96.00
259-167-14-00-3	GASPARIAN MANOUK MIKE	96.00
259-167-20-00-0	JENSEN CURTIS ARLO LIVING TRUST	96.00
259-168-22-00-3	INJEIAN AREK	96.00
259-168-23-00-6	ROMERO JOSE EDUARDO MARTINEZ	96.00
259-168-28-00-1	ALPINE PLAZA LLC	96.00
259-171-01-00-6	MAUCERI MICHAEL ANGELO	96.00
259-171-02-00-9	MAUCERI MICHAEL ANGELO	96.00
259-171-10-00-2	MEJIA ASCENCION	96.00
259-171-15-00-7	HAMBER ROBERT A & KREGEL MARY E	96.00
259-171-18-00-6	WAINRIGHT TR	96.00
259-172-01-00-3	KELLOGG EDMUND C	96.00
259-172-04-00-2	JONES RYAN	96.00
259-173-01-00-0	VALDERRAMO MIGUEL ANGEL & DOLORES	96.00
259-173-07-00-8	TURNER FMLY TR	96.00
259-173-09-00-4	GEORGE MELISSA E	96.00
259-173-10-00-6	GEORGE MELISSA E	96.00
259-173-11-00-9	GEORGE MELISSA E	96.00
259-173-12-00-2	TREVINO RICHARD J	96.00
259-173-13-00-5	TREVINO RICHARD J	96.00
259-173-18-00-0	KADLEC SHAUN TRAVIS	96.00
259-176-06-00-6	MILLER DEBORAH TEXEIRA	96.00
259-177-08-00-9	LAGUNA LARRY ULISES	96.00
259-177-10-00-4	LAGUNA LARRY ULISES	96.00
259-177-11-00-7	LAGUNA LARRY ULISES	96.00
259-177-12-00-0	LAGUNA LARRY ULISES	96.00
259-177-13-00-3	LAGUNA LARRY ULISES	96.00
259-177-15-00-9	BIERER CURTIS W	96.00
259-177-18-00-8	KIDD TR	96.00
259-177-19-00-1	PERRY EDWIN J & GLORIA A	96.00
259-177-22-00-9	BIERER ROBERT W	96.00
259-177-23-00-2	HOCK JOSEPH	96.00
259-178-02-00-8	HAKOBYAN SEVAK	96.00
259-178-09-00-9	HAKOBYAN SEVAK	96.00
259-179-03-00-8	KHOPSHANOSOVA ADELAIDA	96.00

Frazier Park Public Utility District  
 Water Standby Assessment District No. 2025-1  
 Assessment Roll FY 2025/26

<u>Assessor's Parcel Number</u>	<u>Owner Name</u>	<u>Fiscal Year 2025/26 Levy</u>
259-179-07-00-0	HERRERA SILVIA	96.00
259-179-10-00-8	MECHELIN R GREGG & DE LA TORRE BLANCA OFELIA	96.00
259-179-11-00-1	VAN BURT	96.00
259-179-17-00-9	MORRIS JAMES	96.00
259-179-19-00-5	VAN BURT	96.00
259-181-01-00-9	AZER SHARIF SHAUN & LILIANNE	96.00
259-181-02-00-2	MAZZEO CAMILLO & LIANA	96.00
259-182-02-00-9	TENENBAUM ESTELLE	96.00
259-182-05-00-8	LEOS RAFAEL & REBECCA D	96.00
259-182-06-00-1	LEOS RAFAEL & REBECCA D	96.00
259-182-07-00-4	LEOS RAFAEL JR & REBECCA D	96.00
259-182-08-00-7	LEOS RAFAEL JR & REBECCA	96.00
259-182-10-00-2	LEOS RAFAEL JR & REBECCA D	96.00
259-183-11-00-2	BRANCH MARY LOU REV LIVING TRUST	96.00
259-183-14-00-1	BRANCH MARY LOU REV LIVING TRUST	96.00
259-184-01-00-0	VILLEGAS JAKE & GUILLERMINA	96.00
259-185-01-00-7	DE GRANDCHAMP JACK A	96.00
259-185-03-00-3	STEARNS JAMES B	96.00
259-185-07-00-5	STEARNS JAMES B	96.00
259-186-01-00-4	GORDON DAVID J	96.00
259-186-02-00-7	GORDON DAVID J	96.00
259-187-01-00-1	BURK HARRY J	96.00
259-187-02-00-4	MORRIS STEVEN T REVOCABLE TRUST	96.00
259-187-04-00-0	MC DONALD AMY M	96.00
259-187-06-00-6	YANCEY STEVEN G & PAMELA A	96.00
259-187-13-00-6	ZHAO XINXIN	96.00
260-021-05-00-4	WU SUE	96.00
260-021-06-00-7	LOPEZ LEONARDO	96.00
260-021-09-00-6	DEVER FILPATRICK L	96.00
260-021-13-00-7	DEVER JOHN LEE & DIANN M	96.00
260-021-16-00-6	HUNTER BERNICE L TR	96.00
260-021-17-00-9	CRANE TIMOTHY P	96.00
260-021-19-00-5	CRANE TIMOTHY P	96.00
260-022-01-00-9	LOSKOUTNIKOV MAXIM	96.00
260-022-02-00-2	KNIGHT JAMES E	96.00
260-022-03-00-5	FARISS ROBERT R & MARGARET M	96.00
260-022-04-01-7	YRIBE AMELIA	96.00
260-022-04-02-6	YRIBE SELENA	96.00
260-022-10-00-5	CASAS MONICA	96.00
260-022-19-00-2	LOPEZ STEVEN A	96.00
260-022-25-00-9	HALLMARK FMLY TR	96.00
260-022-27-00-5	SMITH EVAN	96.00

Frazier Park Public Utility District  
 Water Standby Assessment District No. 2025-1  
 Assessment Roll FY 2025/26

<u>Assessor's Parcel Number</u>	<u>Owner Name</u>	<u>Fiscal Year 2025/26 Levy</u>
260-022-31-00-6	DEVER DI ANN M	96.00
260-022-32-00-9	CA BEST HOMES INC	96.00
260-024-04-00-2	COUNTY OF KERN	96.00
260-025-04-00-9	COOPER WILLIAM SCOTT	96.00
260-025-09-00-4	COUNTY OF KERN	96.00
260-025-10-00-6	COUNTY OF KERN	96.00
260-026-06-00-2	DUENCKEL DARBY	96.00
260-026-07-00-5	MULLER ROLAND & CARLA	96.00
260-026-08-00-8	KHALILI ROHI	96.00
260-026-09-00-1	FAUCHER ROLAND & PATRICIA TR	96.00
260-026-10-00-3	FAUCHER ROLAND & PATRICIA TR	96.00
260-026-12-00-9	GEORGE FAMILY TRUST	96.00
260-026-15-00-8	POTTER EARL TR	96.00
260-026-16-00-1	WHEELER FAMILY REVOCABLE LIVING TRUST	96.00
260-026-23-00-1	DILL JOHN B	96.00
260-027-02-00-7	GILANI HOSSEIN H T & DOROTHY	96.00
260-027-04-00-3	ZHAMHARYAN TATEVIK	96.00
260-027-05-00-6	DAKAN SEANN SHALLISH	96.00
260-027-06-00-9	LANGSFELD GREG & JANET M	96.00
260-027-07-00-2	PETERSEN FAMILY TRUST	96.00
260-027-12-00-6	GILANI HOSSEIN H T & DOROTHY	96.00
260-028-02-00-4	LANGSFELD GREG L & JANET M	96.00
260-028-03-00-7	LANGSFELD GREG & JANET	96.00
260-031-02-00-8	HILL DOUGLASS	96.00
260-031-05-00-7	REILLY LYNN	96.00
260-031-09-00-9	SINGH RAMMOHAN FAMILY TRUST	96.00
260-031-11-00-4	SAEFKE RICHARD & GAIL D	96.00
260-031-12-00-7	MC NAMARA ROBERT J & DOMINIC W	96.00
260-031-13-00-0	MC CULLOUGH BERTHA ET AL	96.00
260-031-17-00-2	SINGH RAMMOHAN FAMILY TRUST	96.00
260-032-02-00-5	ZIMMERMAN AI LOAN H	96.00
260-032-19-00-5	PONCE BERNARDO RUIZ	96.00
260-033-19-00-2	MARRACCINO TRUST	96.00
260-034-02-00-9	COLEMAN AMANDA L	96.00
260-034-12-00-8	MILLER NELLIE & CHARLOTTE	96.00
260-034-17-00-3	PETROSYAN DAVIT	96.00
260-034-19-00-9	ROSS WILNA JUNE	96.00
260-034-20-00-1	ROSS WILNA JUNE	96.00
260-034-21-00-4	ROSS WILNA JUNE	96.00
260-034-22-00-7	SILVER BEAR PROP	96.00
260-034-24-00-3	WREN ROBERT ALLEN & RHONDA JEAN	96.00
260-034-32-00-6	WREN ROBERT ALLEN & RHONDA JEAN	96.00

Frazier Park Public Utility District  
 Water Standby Assessment District No. 2025-1  
 Assessment Roll FY 2025/26

<u>Assessor's Parcel Number</u>	<u>Owner Name</u>	<u>Fiscal Year 2025/26 Levy</u>
260-034-33-00-9	MACINNIS TRUST	96.00
260-034-34-00-2	COFFEE CARL TR	96.00
260-034-35-00-5	DILL JOHN & SHELLEY	96.00
260-035-09-00-7	MYERS STANLEY E & NORMA J TR	96.00
260-036-01-00-0	DE HOJOS LINDA M	96.00
260-036-02-00-3	DE HOJOS LINDA M	96.00
260-036-03-00-6	CAVERHILL KENNETH D & DEBORAH A	96.00
260-041-30-00-2	GALSTYAN ANAHIT	96.00
260-041-34-00-4	TOROSYAN KARINE IRREVOCABLE TRUST	96.00
260-041-36-00-0	ALLISON JERRY J & MARY	96.00
260-041-37-00-3	VERTREES PAMELA	96.00
260-041-43-00-0	ALLISON JERRY J & MARY	96.00
260-042-09-00-9	GIULIANA VISTA GP	96.00
260-042-12-00-7	GRIGORIAN LIANNA	96.00
260-042-19-00-8	GRIGORIAN LIANNA	96.00
260-043-02-00-5	DILL JOHN & SHELLEY	96.00
260-043-06-00-7	WITT SHARON	96.00
260-043-07-00-0	STEMPORA ROBERT J & JULIA	96.00
260-043-18-00-2	SHAW CAROL DENISE	96.00
260-043-21-00-0	DUNCAN WALTER DAVID	96.00
260-043-25-00-2	DENHAM SHEREE A	96.00
260-043-27-00-8	SECRETARY OF VETERANS AFFAIRS	96.00
260-043-28-00-1	SECRETARY OF VETERANS AFFAIRS	96.00
260-043-29-00-4	HUNT DAN PATRICK ET AL	96.00
260-043-30-00-6	KINEG DOUGLAS & FAVIOLA	96.00
260-043-32-00-2	LABELLA ROBERT	96.00
260-043-37-00-7	NAGEL ANDREW S	96.00
260-044-11-00-8	DAVIS DONALD G & DARLA	96.00
260-044-19-00-2	TIMMONS CURTIS	96.00
260-044-25-00-9	CASTRO JENNIFER	96.00
260-044-27-00-5	GUILTNER CLAYTON W & ERIN E	96.00
260-044-29-00-1	CRUSE KATY M FAMILY TRUST	96.00
260-044-30-00-3	KHALIL SAMEER F	96.00
260-044-32-00-9	KANE FAMILY TRUST	96.00
260-044-37-00-4	TIMMONS CURTIS	96.00
260-044-42-00-8	BLUE PACIFIC HOLDING INC	96.00
260-045-01-00-6	FARAGHER FAMILY TRUST	96.00
260-045-03-00-2	CASTRO EDGAR MAURICIO	96.00
260-045-04-00-5	GONZALEZ J NIEVES AVILA	96.00
260-045-05-00-8	MANN MICHAEL R & CRAIG MARILYN	96.00
260-045-09-00-0	FARRINGER ANDRE & CASSANDRA	96.00
260-045-11-00-5	CLINE LAWRENCE W & PATRICIA A	96.00



Frazier Park Public Utility District  
 Water Standby Assessment District No. 2025-1  
 Assessment Roll FY 2025/26

<u>Assessor's Parcel Number</u>	<u>Owner Name</u>	<u>Fiscal Year 2025/26 Levy</u>
260-045-14-00-4	CLINE LAWRENCE W & PATRICIA A	96.00
260-045-16-00-0	WARREN DANIEL V	96.00
260-045-17-00-3	WARREN DANIEL V	96.00
260-045-19-00-9	PYLE STANLEY L & CHRISTINE	96.00
260-045-23-00-0	MANN MICHAEL R & CRAIG MARILYN	96.00
260-045-24-00-3	GONZALEZ J NIEVES AVILA	96.00
260-045-25-00-6	GONZALEZ J NIEVES AVILA	96.00
260-045-28-00-5	VAUGHN FAMILY TRUST	96.00
260-045-29-00-8	BAVARO DEBBIE	96.00
260-045-35-00-5	PYLE STANLEY L & CHRISTINE	96.00
260-051-04-00-0	PAGE MELVIN HOWARD & ROSALYN	96.00
260-051-12-00-3	ROSALES JOHNNY M & KIM	96.00
260-051-13-00-6	RIBAN JOHN DALE TRUST	96.00
260-051-14-00-9	RYAN EDWARD & ANGELA	96.00
260-051-15-00-2	DUVERNAY JOSEPH M JR	96.00
260-051-16-00-5	KNEER MACKEY PAULETTE JEAN TR	96.00
260-051-17-00-8	WELLS FARGO BK N A	96.00
260-051-18-00-1	JENNINGS CLARK A	96.00
260-051-19-00-4	KAYE SHARON	96.00
260-051-20-00-6	KAYE SHARON	96.00
260-051-21-00-9	SALZMAN GARY	96.00
260-051-22-00-2	MAQ DEVELOPERS LLC	96.00
260-051-26-00-4	PAGE MELVIN & ROSALYN	96.00
260-051-27-00-7	KNEER MACKEY LIVING TRUST	96.00
260-051-28-00-0	KNEER MACKEY PAULETTE TR	96.00
260-051-29-00-3	DUVERNAY JOSEPH M JR	96.00
260-051-33-00-4	KAYE SHARON	96.00
260-051-36-00-3	GILBRETH ROBERT M	96.00
260-051-40-00-4	VAN BRADLEY P & KAREN	96.00
260-052-11-00-7	GAZE EMMA	96.00
260-052-13-00-3	BIERER ARTHUR & DARLENE	96.00
260-052-26-00-1	LOPEZ ANGEL F SALINAS & GUARNEROS MARIA D	96.00
260-053-02-00-8	RIVETTE RYAN M & AMBER N	96.00
260-053-06-00-0	LANGSFELD KELLY L & JENNIFER L	96.00
260-053-07-00-3	LEE GREGORY LEE & LANGSFELD JANET M	96.00
260-054-05-00-4	GARCIA PEDRO & VERONICA	96.00
260-054-06-00-7	WALTER PAUL JOSEPH	96.00
260-054-09-00-6	MC MAHAN PATRICK	96.00
260-054-12-00-4	WALTER PAUL JOSEPH	96.00
260-054-17-00-9	WOLF RENEE	96.00
260-054-18-00-2	WOLF RENEE	96.00
260-061-01-00-4	HIGHTOWER MICHAEL	96.00

Frazier Park Public Utility District  
Water Standby Assessment District No. 2025-1  
Assessment Roll FY 2025/26

<u>Assessor's Parcel Number</u>	<u>Owner Name</u>	<u>Fiscal Year 2025/26 Levy</u>
260-061-02-00-7	HIGHTOWER MICHAEL	96.00
260-061-03-00-0	SALINAS NANCY	96.00
260-061-05-00-6	SALINAS NANCY	96.00
260-061-06-00-9	SALINAS NANCY	96.00
260-061-07-00-2	SALINAS NANCY	96.00
260-062-02-00-4	SALINAS ANGEL	96.00
260-062-03-00-7	HINZ MARTIN & DOLLAR JANET BARBARA	96.00
260-062-07-00-9	HILTON MICHAEL & JOANN REV TR	96.00
260-062-08-00-2	SMITH ROBERT & SANDRA VAP TR	96.00
260-062-09-00-5	CORDER ZANNA E	96.00
260-062-10-00-7	COFFEE CARL 401K PROFIT SHARING PLAN	96.00
260-062-11-00-0	MILLER VINCE	96.00
260-062-13-00-6	MILLER VINCE	96.00
260-062-16-00-5	THANH RANDY	96.00
260-062-17-00-8	LUTZ ARNOLD	96.00
260-063-04-00-7	POSADA CARLOS MARIO PALACIO	96.00
260-063-07-00-6	FRASCHETTI LEO J & ELSA A FAMILY TRUST	96.00
260-063-10-00-4	DE FEO ROBERT A TRUST	96.00
260-064-02-00-8	MULLER ROLAND & CARLA	96.00
260-064-03-00-1	MULLER ROLAND & CARLA	96.00
260-064-07-00-3	PISTOLE BRADLEY GORDON	96.00
260-064-08-00-6	CHEN LILI	96.00
260-064-09-00-9	VALPREDO GINO FAMILY TRUST	96.00
260-064-13-00-0	TOMASHEVSKI PETER	96.00
260-064-14-00-3	FRAZIER PARK PROERTIES LLC	96.00
260-064-16-00-9	KHALIL SAMEER F	96.00
260-064-18-00-5	HOPKINS VALERIE K	96.00
260-064-19-00-8	TOMASHEVSKI PETER	96.00
260-064-20-00-0	TOMASHEVSKI PETER	96.00
260-067-04-00-5	ATWATER STEPHEN K & CHRISTINE ET AL	96.00
260-067-09-00-0	SPECHT WILLIAM	96.00
260-067-12-00-8	GOCKEL MICHAEL P & BILLIE JEAN	96.00
260-068-02-00-6	HRIBAR MICHAEL	96.00
260-081-09-00-4	SWANSON BARBARA SHELLY	96.00
260-081-10-00-6	SWANSON BARBARA SHELLY	96.00
260-081-19-00-3	BROWN LARRY E & CANDACE K HUSKEY	96.00
260-082-07-00-5	YOUNG JAMES C ET AL	96.00
260-083-14-00-2	NUSSBAUM RAPHAEL & JUTTA	96.00
260-083-16-00-8	NUSSBAUM FAMILY TR	96.00
260-083-17-00-1	SEPULVEDA ELOISA SANDRA	96.00
260-083-20-00-9	NUSSBAUM RAPHAEL TR	96.00
260-083-21-00-2	NUSSBAUM RAPHAEL TR	96.00

Frazier Park Public Utility District  
Water Standby Assessment District No. 2025-1  
Assessment Roll FY 2025/26

<u>Assessor's Parcel Number</u>	<u>Owner Name</u>	<u>Fiscal Year 2025/26 Levy</u>
260-083-23-00-8	GLAZE FAM LIV TR	96.00
260-083-27-00-0	HUNTER TODD S	96.00
260-084-01-00-1	GUADAGNIN DAVID & WHITEHAIR E	96.00
260-084-02-00-4	CAVE RONALD A & MICHELE	96.00
260-084-09-00-5	EGAN FAMILY TRUST 2009	96.00
260-084-13-00-6	VIANO HAEUSSLER FAMILY 2021 REV TRUST	96.00
260-084-15-00-2	MARSON FAMILY TRUST	96.00
260-084-16-00-5	VIANO HAEUSSLER FAMILY 2021 REV TRUST	96.00
260-085-10-00-4	WONG ANDREW Y C & MARION	96.00
260-085-13-00-3	PACHON PAOLA	96.00
260-085-16-00-2	WONG ANDREW Y C & MARION	96.00
260-091-01-00-3	YEAGER GARY M	96.00
260-091-04-00-2	WIECZOREK ANNA TRUST	96.00
260-091-05-00-5	NUSSBAUM BRENT HAROLD	96.00
260-091-06-00-8	WICKLIFFE DANA	96.00
260-091-07-00-1	HERMAN RON	96.00
260-091-08-00-4	HERMAN RON	96.00
260-091-09-00-7	HERMAN RON	96.00
260-091-11-00-2	MOSES AZAD V	96.00
260-091-18-00-3	WHITMAN RICHARD & KIMBERLY A	96.00
260-091-21-00-1	SANCHEZ PETER	96.00
260-091-23-00-7	ROSSETTI ANTHONY F	96.00
260-091-24-00-0	ROSSETTI ANTHONY	96.00
260-092-02-00-3	GARCIA TIM FAMILY TRUST	96.00
260-092-03-00-6	BOEMMELS DAVID J & CONNIE L FMLY TR	96.00
260-093-01-00-7	ALMACETI VERONICA	96.00
260-093-03-00-3	BROWN ROBERT ANTHONY	96.00
260-093-05-00-9	BARKER DENNIS M & ET AL	96.00
260-093-09-00-1	HUSKEY CANDACE K & LARRY E BROWN TRUST	96.00
260-093-20-00-2	BHOGAL HARPREET	96.00
260-093-21-00-5	BHOGAL HARPREET	96.00
260-093-22-00-8	BHOGAL HARPREET	96.00
260-093-26-00-0	DURACK ALEXSEI & FULFORD COLIN R	96.00
260-093-28-00-6	BARKER DENNIS & JOAN	96.00
260-093-30-00-1	SOLORIO REGINA	96.00
260-094-01-00-4	VARBEL LAUNI L	96.00
260-094-02-00-7	VARBEL LAUNI L	96.00
260-094-03-00-0	CANYON PROP LLC	96.00
260-094-04-00-3	SOBEL WILLIAM ALAN	96.00
260-094-05-00-6	SOBEL WILLIAM ALAN	96.00
260-094-06-00-9	ROMERO JESUS FRANCISCO	96.00
260-094-07-00-2	ZUO PINGDI & CHEN LILI	96.00

Frazier Park Public Utility District  
 Water Standby Assessment District No. 2025-1  
 Assessment Roll FY 2025/26

<u>Assessor's Parcel Number</u>	<u>Owner Name</u>	<u>Fiscal Year 2025/26 Levy</u>
260-095-07-00-9	WOLF THOMAS R & DEBORAH A 2008 TRUST	96.00
260-095-12-00-3	ROLLINS MARIA ELENA	96.00
260-095-13-00-6	CORONADO MARIE E	96.00
260-095-18-00-1	GARCIA JUAN & SONIA A REVOCABLE TRUST	96.00
260-095-26-00-4	DEVENNY RYAN	96.00
260-096-01-00-8	PRATT ANTHONY L & MARJU K	96.00
260-097-03-00-1	RIBAN MICHAEL FAMILY TRUST	96.00
260-097-11-00-4	TREANOR PATRICK & SHERI	96.00
260-097-13-00-0	REGIS ALGIS	96.00
260-097-16-00-9	MARROQUIN ALEX BRANDON	96.00
260-097-17-00-2	MELLON LOUIS L JR	96.00
260-097-19-00-8	TOSTENSON DONALD W & PATRICIA C	96.00
260-097-25-00-5	BORGSTROM LANCE S & SHELLEY FAMILY TR	96.00
260-097-28-00-4	VAN BURT L JR	96.00
260-097-34-00-1	BAILEY FMLY TR	96.00
260-098-03-00-8	FLORES JOSE DIAZ	96.00
260-098-04-00-1	FLORES JOSE DIAZ	96.00
260-098-08-00-3	VAN BURT L JR	96.00
260-098-09-00-6	VAN BURT L JR	96.00
260-098-10-00-8	VAN BURT L JR	96.00
260-098-14-00-0	FLORES JOSE DIAZ	96.00
260-098-15-00-3	FLORES JOSE DIAZ	96.00
260-098-17-00-9	FLORES JOSE DIAZ	96.00
260-098-18-00-2	BORGSTROM DANE	96.00
260-098-25-00-2	FLORES JOSE DIAZ	96.00
260-098-26-00-5	FLORES JOSE DIAZ	96.00
260-098-27-00-8	FLORES JOSE DIAZ	96.00
260-098-28-00-1	MARTIN MATTHEW	96.00
260-098-34-00-8	SALVAGGIO MARK CHARLES & LAURA LEAH T	96.00
260-098-35-00-1	MARTIN MATTHEW	96.00
260-101-02-00-8	PONCE MICHELLE VERONICA	96.00
260-101-03-00-1	TKACHUK SARAH N TR ET AL	96.00
260-101-04-00-4	WILTSEE KENNETH SCOTT	96.00
260-101-05-00-7	WILTSEE KENNETH SCOTT	96.00
260-101-06-00-0	ROBISON JEFFREY A & JANE A	96.00
260-101-08-00-6	WILTSEE KENNETH S	96.00
260-101-10-00-1	ANDREWS STEPHEN B	96.00
260-102-05-00-4	METZGER JOHN	96.00
260-102-06-00-7	METZGER JOHN	96.00
260-102-07-00-0	METZGER JOHN	96.00
260-102-08-00-3	NARANJO SILVIA CARDENAS	96.00
260-102-10-00-8	KUH BERNARD	96.00

Frazier Park Public Utility District  
 Water Standby Assessment District No. 2025-1  
 Assessment Roll FY 2025/26

<u>Assessor's Parcel Number</u>	<u>Owner Name</u>	<u>Fiscal Year 2025/26 Levy</u>
260-102-18-00-2	HIDALGO ROXANE M	96.00
260-102-19-00-5	HIDALGO ROXANE M	96.00
260-102-23-00-6	MEIER STEVEN FRANK CHILDS EXEMPT TRUST	96.00
260-102-25-00-2	NARANJO SILVIA CARDENAS	96.00
260-102-32-00-2	BOTTS STEPHEN E & KATE	96.00
260-102-35-00-1	METZGER JOHN W REVOCABLE LIVING TRUST	96.00
260-102-39-00-3	RENNA LYNDA M	96.00
260-103-01-00-9	OWENS LONNIE JAMES & HUDGENS LINDA LILLY	96.00
260-103-05-00-1	RAMEY SCOTT & SUSAN	96.00
260-103-06-00-4	RAMEY SCOTT & SUSAN	96.00
260-103-08-00-0	SILBER CAILTIN MC GILLIVRAY	96.00
260-103-11-00-8	MEKJIAN GEORGE & LUCY TRUST	96.00
260-103-12-00-1	MEKJIAN GEORGE & LUCY FAMILY TRUST	96.00
260-103-14-00-7	RODRIGUEZ MAUREEN	96.00
260-103-18-00-9	RUST SHANE	96.00
260-103-19-00-2	PEREZ SAUL PEREZ	96.00
260-103-21-00-7	DA LESSIO ANTHONY J	96.00
260-103-22-00-0	PAGE MELVIN & ROSALYN	96.00
260-103-23-00-3	RAMEY SCOTT & SUSAN	96.00
260-103-24-00-6	RAMEY SCOTT & SUSAN	96.00
260-103-30-00-3	OWENS DAVID B	96.00
260-103-32-00-9	MATEUS ANIBAL X	96.00
260-103-33-00-2	FEIR FAMILY TRUST	96.00
260-104-07-00-4	HOWARTH SAMANTHA LEA	96.00
260-104-09-00-0	NGUYEN THINH Q & MAI TUYET	96.00
260-104-12-00-8	HOWARTH SAMANTHA LEA	96.00
260-104-13-00-1	MENGEL JEANINE	96.00
260-105-06-00-8	ALLISON JONNIE E & HEATHER L	96.00
260-105-08-00-4	BRICENO LIZETTE	96.00
260-105-14-00-1	ALBERYD EMANUEL & LOPEZ ANA CELIA	96.00
260-105-22-00-4	PIVEN KOSTIANTYN & DRONYK STANISLAV	96.00
260-105-26-00-6	MEISTER BRANDON TOSHIO & CHELSEA MARIE	96.00
260-106-05-00-2	HALABY BASSAM & AIDA	96.00
260-106-08-00-1	YOUNG CAROL J & MICHAEL	96.00
260-106-23-00-4	GENTRY GRANT D	96.00
260-107-02-00-0	CONNER ROSEMARY	96.00
260-107-03-00-3	MEJIA JUAN V & SOLEDAD O	96.00
260-107-08-00-8	MOORE MARCELA HEREDIA	96.00
260-111-07-00-6	ZIMMERMAN ROBERT K 2022 TRUST	96.00
260-111-08-00-9	PINA MARTIN G & ISABEL R DE GUERRERO	96.00
260-111-11-00-7	WILLIAMS DONALD E	96.00
260-111-15-00-9	MURCHISON RAY & DENISE	96.00

Frazier Park Public Utility District  
 Water Standby Assessment District No. 2025-1  
 Assessment Roll FY 2025/26

<u>Assessor's Parcel Number</u>	<u>Owner Name</u>	<u>Fiscal Year 2025/26 Levy</u>
260-111-16-00-2	RANSELL DENISE W & RICK	96.00
260-111-17-00-5	MYREN GUSTAF	96.00
260-111-18-00-8	BLUE PACIFIC HOLDING INC	96.00
260-111-19-00-1	FERRARA ROY D & DONNA	96.00
260-111-22-00-9	TKACHUK SARAH N TR ET AL	96.00
260-111-26-00-1	WEISBERG ROBERT K	96.00
260-111-27-00-4	BELLER LEONARD & SANDRA TRUST	96.00
260-111-30-00-2	MOORE NANCY J TRUST	96.00
260-111-34-00-4	FREET FAMILY TRUST	96.00
260-112-02-00-8	BUMGARDNER DAVID E	96.00
260-113-02-00-5	EUBANK DONALD W & JACKIE D	96.00
260-113-03-00-8	EUBANK DONALD & JACKIE	96.00
260-113-05-00-4	MISER RANDALL D	96.00
260-114-07-00-7	COOPER SEBASTIAN FAMILY TRUST	96.00
260-115-01-00-6	BERNHARDT PETER OTTO JR	96.00
260-115-02-00-9	BERNHARDT PETER OTTO JR	96.00
260-115-03-00-2	BERNHARDT PETER O	96.00
260-115-05-00-8	BERNHARDT PETER O	96.00
260-115-06-00-1	STAHL DENNIS J & CHERYL	96.00
260-115-08-00-7	MOORE NANCY J TRUST	96.00
260-115-10-00-2	HOVSEPYAN LEON	96.00
260-115-11-00-5	HOVSEPYAN LEON	96.00
260-115-12-00-8	NUSSBAUM RAPHAEL TR	96.00
260-115-17-00-3	HOVSEPYAN LEON	96.00
260-115-18-00-6	MOORE NANCY J TRUST	96.00
260-115-21-00-4	BERNHARDT PETER OTTO JR	96.00
260-115-26-00-9	MOORE NANCY J TRUST	96.00
260-115-27-00-2	MOORE NANCY J TRUST	96.00
260-115-28-00-5	MOORE NANCY J TRUST	96.00
260-116-03-00-9	RIBAN JOHN DALE TR	96.00
260-116-04-00-2	RIBAN JOHN DALE TR	96.00
260-116-05-00-5	PACHECO FAMILY TRUST	96.00
260-116-07-00-1	ABAJIAN RANDY	96.00
260-116-08-00-4	MISEROY RICHARD L & ANITA M	96.00
260-116-09-00-7	MISEROY RICHARD L & ANITA M	96.00
260-116-15-00-4	PACHECO FAMILY TRUST	96.00
260-116-19-00-6	POIRIER GEORGE & JEAN	96.00
260-117-02-00-3	YEAGER GARY M	96.00
260-117-08-00-1	HERMAN RONALD & JOAN	96.00
260-117-09-00-4	HERMAN RONALD & JOAN	96.00
260-117-10-00-6	SMET ANTHONY R	96.00
260-117-12-00-2	SMET ANTHONY ROBERT	96.00

Frazier Park Public Utility District  
 Water Standby Assessment District No. 2025-1  
 Assessment Roll FY 2025/26

<u>Assessor's Parcel Number</u>	<u>Owner Name</u>	<u>Fiscal Year 2025/26 Levy</u>
260-117-15-00-1	PENCE BILLIE JEAN	96.00
260-117-18-00-0	SMET ANTHONY R	96.00
260-118-04-00-6	ROSALES THOMAS JR & JOYCE J	96.00
260-118-05-00-9	ROSALES THOMAS JR & JOYCE J	96.00
260-118-06-00-2	CHO MIRA	96.00
260-118-09-00-1	ROSALES THOMAS & JOYCE	96.00
260-118-16-00-1	ROSALES THOMAS JR & JOYCE J	96.00
260-119-02-00-7	WILLIAMS MAX A & CINTHIA J	96.00
260-119-03-00-0	CANYON PROPERTIES LLC	96.00
260-121-03-00-7	GREATER MT PENTECOSTALS	96.00
260-121-04-00-0	GREATER MT PENTECOSTALS	96.00
260-121-05-00-3	GREATER MT PENTECOSTALS	96.00
260-122-04-00-7	PARKER MS & KE FAMILY TRUST	96.00
260-122-10-00-4	RICHER CLARENCE E & ELOISE A	96.00
260-122-11-00-7	RICHER CLARENCE E & ELOISE A	96.00
260-122-12-00-0	RICHER CLARENCE E & ELOISE A	96.00
260-122-14-00-6	HIWA RICHARD S & RUISI DEBORAH J	96.00
260-122-15-00-9	RICHER CLARENCE E & ELOISE A	96.00
260-122-17-00-5	CHURCH MILDRED TRUST	96.00
260-122-20-00-3	MELLON LOUIS	96.00
260-122-21-00-6	PRICE CYNTHIA D	96.00
260-122-22-00-9	SARDO JAIS A	96.00
260-122-23-00-2	SARDO JAIS A	96.00
260-122-29-00-0	ANDRADE FELICIANO & DIAZ MARICELA	96.00
260-122-30-00-2	PEREZ PEREZ SAUL	96.00
260-123-02-00-8	KRAMER TYLER J	96.00
260-123-03-00-1	KRAMER TYLER	96.00
260-123-07-00-3	WHITMORE L K & WALTER ROBT P	96.00
260-123-08-00-6	BOYD KAREN C LIVING TRUST	96.00
260-124-03-00-8	BOGGS PATRICIA A & BOYD JEFF J	96.00
260-124-04-00-1	BOGGS PATRICIA A & BOYD JEFF J	96.00
260-124-06-00-7	RASHIK HUSAIN	96.00
260-124-07-01-9	MELLAS REGIS J	96.00
260-124-07-02-8	MELLAS HELEN	96.00
260-124-08-00-3	MELLAS HELEN	96.00
260-124-12-00-4	AGNEW FAMILY TRUST	96.00
260-124-13-00-7	AGNEW FAMILY TRUST	96.00
260-124-14-00-0	AGNEW FAMILY TRUST	96.00
260-124-20-00-7	AGNEW FAMILY TRUST	96.00
260-125-01-00-9	VAN BURT L & BRADLEY PAUL ET AL	96.00
260-125-03-00-5	GORE STEVEN WILLIAM	96.00
260-125-04-00-8	GORE STEVEN WILLIAM	96.00

Frazier Park Public Utility District  
 Water Standby Assessment District No. 2025-1  
 Assessment Roll FY 2025/26

<u>Assessor's Parcel Number</u>	<u>Owner Name</u>	<u>Fiscal Year 2025/26 Levy</u>
260-125-05-00-1	GORE STEVEN WILLIAM	96.00
260-125-06-00-4	FRIEDL RICK	96.00
260-125-07-00-7	BURK HARRY J	96.00
260-125-08-00-0	BURK HARRY J	96.00
260-125-09-00-3	BROSHEARS RANDOLPH S TR	96.00
260-125-10-00-5	BROSHEARS RANDOLPH S TR	96.00
260-125-11-00-8	BROSHEARS RANDOLPH S TR	96.00
260-125-12-00-1	BROSHEARS RANDOLPH S TR	96.00
260-125-13-00-4	BURK HARRY J	96.00
260-125-14-00-7	BURK HARRY J	96.00
260-125-15-00-0	BURK HARRY J	96.00
260-125-16-00-3	BURK HARRY J	96.00
260-125-17-00-6	FRANCY M C	96.00
260-125-18-00-9	ARAX MANE	96.00
260-125-19-00-2	EDMONDS CECIL B	96.00
260-126-06-00-1	MILLIS ERIC JOHN & FAUTH CHRISTINA RENEE	96.00
260-126-26-00-9	GIBSON FAMILY REVOCABLE TRUST	96.00
260-127-04-00-2	PECORARO FRED B & JOANN	96.00
260-127-11-00-2	MARIN NOE ESAU GUARDADO	96.00
260-127-13-00-8	FRANKLIN JESSICA ANN	96.00
260-127-17-00-0	AI LOAN LIVING TRUST	96.00
260-127-19-00-6	HEILMAN FRANK G III & DAWN A	96.00
260-131-03-00-0	JIMENEZ MARIA ELENA	96.00
260-131-05-00-6	AI LOAN LIVING TRUST	96.00
260-131-06-00-9	AI LOAN LIVING TRUST	96.00
260-131-12-00-6	BOYADJIAN LIVING TRUST	96.00
260-131-13-00-9	MATTE GARY & TIFFANY	96.00
260-132-02-00-4	EFFERTZ TRUST	96.00
260-132-05-00-3	HAMILTON J C ET AL	96.00
260-132-08-00-2	EFFERTZ TRUST	96.00
260-133-01-00-8	CHRISTIAN DANIEL A & TARA A	96.00
260-133-02-00-1	PABLO MARY G V	96.00
260-133-03-00-4	PABLO MARY G V	96.00
260-133-06-00-3	STUNTEBECK THOMAS J	96.00
260-133-11-00-7	RIEDEL FAMILY TRUST	96.00
260-133-13-00-3	RIEDEL FAMILY TRUST	96.00
260-133-14-00-6	BROSHEARS RANDOLPH S TR	96.00
260-133-15-00-9	BROSHEARS RANDOLPH S TR	96.00
260-133-16-00-2	BROSHEARS RANDOLPH S TR	96.00
260-133-17-00-5	BROSHEARS RANDOLPH S TR	96.00
260-133-18-00-8	DAVILA JUAN	96.00
260-133-19-00-1	BROSHEARS RANDOLPH S TR	96.00



Frazier Park Public Utility District  
 Water Standby Assessment District No. 2025-1  
 Assessment Roll FY 2025/26

<u>Assessor's Parcel Number</u>	<u>Owner Name</u>	<u>Fiscal Year 2025/26 Levy</u>
260-133-20-00-3	BROSHEARS RANDOLPH S TR	96.00
260-133-21-00-6	BROSHEARS RANDOLPH S TR	96.00
260-133-22-00-9	BROSHEARS RANDOLPH S TR	96.00
260-133-23-00-2	PABLO MARY G V	96.00
260-133-24-00-5	ARAX MANE	96.00
260-133-27-00-4	WILLIAMS LOHMAR JUDITH	96.00
260-134-09-00-9	GINELL WILLIAM S & SALLY TRUST	96.00
260-135-03-00-8	EVANS RICHARD HENRY	96.00
260-135-04-00-1	SEGURA HERBERT M	96.00
260-135-05-00-4	EVANS RICHARD HENRY	96.00
260-135-06-00-7	MISENHIMER MATTHEW TYLER	96.00
260-135-08-00-3	COYNE DANIEL T & JOAN E TR	96.00
260-135-10-00-8	COYNE DANIEL T & JOAN E TR	96.00
260-135-11-00-1	COYNE DANIEL T & JOAN E TR	96.00
260-135-12-00-4	COYNE DANIEL T & JOAN E TR	96.00
260-135-13-00-7	MISENHIMER MATTHEW TYLER	96.00
260-135-14-00-0	MISENHIMER MATT	96.00
260-135-15-00-3	HERMAN RON	96.00
260-135-17-00-9	ACQUISTAPACE ROMOLO N TR	96.00
260-135-18-00-2	DAY WILLIAM H JR	96.00
260-135-19-00-5	EVANS RICHARD HENRY	96.00
260-136-01-00-9	VAN GEELKERKEN MAE E	96.00
260-136-02-00-2	BAKER D EUGENE REV TR	96.00
260-136-03-00-5	AARABI NIMA	96.00
260-136-04-00-8	HAMBLETON ALLAN F & SUSAN H	96.00
260-136-05-00-1	MACLAREN ESTHER M LIVING TRUST	96.00
260-137-01-00-6	EVANS RICHARD HENRY	96.00
260-137-02-00-9	EVANS RICHARD HENRY	96.00
260-137-03-00-2	BROSHEARS RANDOLPH S TR	96.00
260-137-04-00-5	BROSHEARS RANDOLPH S TR	96.00
260-137-05-00-8	BROSHEARS RANDOLPH S TR	96.00
260-137-06-00-1	BROSHEARS RANDOLPH S TR	96.00
260-137-07-00-4	BROSHEARS RANDOLPH S TR	96.00
260-137-08-00-7	BROSHEARS RANDOLPH S TR	96.00
260-137-09-00-0	ARAX MANE	96.00
260-137-10-00-2	WHITE JACK C & ELAINE K	96.00
260-137-11-00-5	ALIPPI FAM TR	96.00
260-137-12-00-8	VAN BERT L JR & CATHERN A	96.00
260-137-13-00-1	VAN BERT L JR & CATHERN A	96.00
260-137-14-00-4	VAN BURT L JR & CATHERINE F	96.00
260-137-15-00-7	ALIPPI FAM TR	96.00
260-137-16-00-0	ALIPPI FAM TR	96.00

Frazier Park Public Utility District  
Water Standby Assessment District No. 2025-1  
Assessment Roll FY 2025/26

<u>Assessor's Parcel Number</u>	<u>Owner Name</u>	<u>Fiscal Year 2025/26 Levy</u>
260-137-17-00-3	ZUO PINGDI & CHEN LILI	96.00
260-137-18-00-6	ZUO PINGDI & CHEN LILI	96.00
260-137-19-00-9	BROSHEARS RANDOLPH S TR	96.00
260-137-20-00-1	BROSHEARS RANDOLPH S TR	96.00
260-137-21-00-4	BROSHEARS RANDOLPH S TR	96.00
260-137-22-00-7	BROSHEARS RANDOLPH S TR	96.00
260-137-23-00-0	SZEWCZYK ADAM	96.00
260-137-24-00-3	FORSYTHE MARIA	96.00
260-137-25-00-6	BROSHEARS RANDOLPH S TR	96.00
260-137-26-00-9	ARAX MANE	96.00
260-137-27-00-2	BROSHEARS RANDOLPH S	96.00
260-137-28-00-5	BROSHEARS RANDOLPH S REV LIV TR	96.00
260-137-29-00-8	BURK HARRY J	96.00
260-137-30-00-0	BURK HARRY J	96.00
260-137-31-00-3	BURK HARRY J	96.00
260-137-32-00-6	BURK HARRY J	96.00
260-137-33-00-9	TRAUM SANDRA L	96.00
260-137-34-00-2	BROSHEARS RANDOLPH S TR	96.00
260-137-35-00-5	BROSHEARS RANDOLPH S TR	96.00
260-137-36-00-8	BROSHEARS RANDOLPH S TR	96.00
260-137-37-00-1	EVANS RICHARD HENRY	96.00
260-138-09-00-7	FAUCHER ROLAND & PATRICIA TR	96.00
260-138-10-00-9	BAEHR EARL A & CHALLIE M FMLY TR	96.00
260-138-11-00-2	BAEHR CHARLES E & LOIS E FMLY TR	96.00
260-138-12-00-5	NUSSBAUM RAPHAEL & JUTTA TR	96.00
260-138-13-00-8	NUSSBAUM RAPHAEL & JUTTA	96.00
260-138-28-00-2	RIBAN MICHAEL FAMILY TRUST	96.00
260-138-38-00-1	WEINMAN STEPHEN K	96.00
260-141-06-00-2	FOX JACQUES	96.00
260-141-07-00-5	GLOISTEN ROBERT	96.00
260-141-08-00-8	GLOISTEN ROBERT	96.00
260-141-17-00-4	HACKNEY RYAN	96.00
260-141-18-00-7	HACKNEY RYAN	96.00
260-141-19-00-0	SAWANO ARCHITECTS INC	96.00
260-141-20-00-2	SAWANO ARCHITECTS INC	96.00
260-141-28-00-6	VANCE COREY HANSEN & BUCIO ROCHA JOSE	96.00
260-142-02-00-7	BELTRAN HERNANDEZ MARDOQUEO & MARTA I	96.00
260-142-03-00-0	BELTRAN HERNANDEZ MARDOQUEO & MARTA I	96.00
260-142-04-00-3	LANDHERR STEPHEN J	96.00
260-143-01-00-1	RUOFF W DOUGLAS JR LIVING TRUST	96.00
260-143-02-00-4	LEAVELLE DONALD & HELEN E	96.00
260-143-03-00-7	LEAVELLE DONALD & HELEN E	96.00

Frazier Park Public Utility District  
Water Standby Assessment District No. 2025-1  
Assessment Roll FY 2025/26

<u>Assessor's Parcel Number</u>	<u>Owner Name</u>	<u>Fiscal Year 2025/26 Levy</u>
260-143-04-00-0	LEAVELLE DONALD & HELEN E	96.00
260-143-05-00-3	ORRIN FAMILY TRUST	96.00
260-143-09-00-5	SCHOENWALD ANJA	96.00
260-143-10-00-7	KHALIL MANHAL & ROUAA	96.00
260-143-16-00-5	HERNANDEZ MATTHEW T	96.00
260-143-18-00-1	KHALIL MANHAL & ROUAA	96.00
260-143-19-00-4	BLACKBURN FREDRICK JACOB JR TR	96.00
260-144-02-00-1	LAUZON CHRISTINE	96.00
260-145-01-00-5	HARTMAN ABIGAIL	96.00
260-145-02-00-8	HUDSON MILTON	96.00
260-145-05-00-7	PAVADE FAMILY TRUST	96.00
260-145-06-00-0	PAVADE FAM TRUST	96.00
260-145-09-00-9	WAHLER DONALD E & WHITE RALPH	96.00
260-145-10-00-1	WAHLER DONALD LIV TR	96.00
260-145-11-00-4	WAHLER DONALD LIV TR	96.00
260-145-12-00-7	WAHLER DONALD LIV TR	96.00
260-145-13-00-0	COTTRELL RICK J TR	96.00
260-145-14-00-3	BOYER HAROLD C JR	96.00
260-145-15-00-6	GARCIA MARIO LOPEZ & MARIA DOLORES	96.00
260-145-16-00-9	BROSHEARS RANDOLPH S TR	96.00
260-145-17-00-2	BROSHEARS RANDOLPH S TR	96.00
260-145-18-00-5	MUNOZ STELLA	96.00
260-145-19-00-8	MUNOZ STELLA	96.00
260-145-20-00-0	ZUO PINGDI & CHEN LILI	96.00
260-145-21-00-3	ZUO PINGDI & CHEN LILI	96.00
260-146-01-00-2	NUNEZ ANTHONY E	96.00
260-146-02-00-5	GARCIA PEDRO & VERONICA	96.00
260-146-03-00-8	PERRELL ANTOINETTE C	96.00
260-146-04-00-1	LUCHT WILLIAM J	96.00
260-146-05-00-4	JACOBSON DOUGLAS C	96.00
260-146-06-00-7	COLTRIN LORI	96.00
260-146-07-00-0	ALLEN MONTGOMERY B	96.00
260-146-08-00-3	ALLEN FAMILY TRUST A	96.00
260-146-09-00-6	BAKER LARRY	96.00
260-146-17-00-9	MORA SERGIO	96.00
260-146-18-00-2	MORA SERGIO	96.00
260-146-19-00-5	THOMAS VICKY L TR	96.00
260-146-20-00-7	THOMAS VICKY L TR	96.00
260-146-21-00-0	RHOADS RICHARD	96.00
260-146-22-00-3	ZUO PINGDI & CHEN LILI	96.00
260-146-23-00-6	NIKKEL DONALD L	96.00
260-146-24-00-9	MELTON PEARL	96.00

Frazier Park Public Utility District  
 Water Standby Assessment District No. 2025-1  
 Assessment Roll FY 2025/26

<u>Assessor's Parcel Number</u>	<u>Owner Name</u>	<u>Fiscal Year 2025/26 Levy</u>
260-146-25-00-2	MANTOR SHAWN P	96.00
260-146-26-00-5	LUTZ ARNOLD	96.00
260-146-27-00-8	RODRIGUEZ JOSE RAMON	96.00
260-146-28-00-1	VALOV WILLIAM FRED REV TRUST	96.00
260-146-29-00-4	LEWY SUSANNA A	96.00
260-146-30-00-6	ZUO PINGDI & CHEN LILI	96.00
260-146-31-00-9	LUCHT WILLIAM J LIVING TRUST	96.00
260-146-32-00-2	PERRELL ANTOINETTE C	96.00
260-146-33-00-5	PERRELL ANTOINETTE C	96.00
260-146-35-00-1	SARIS PHILLIP	96.00
260-146-37-00-7	BADASCI MATT & CASEY	96.00
260-147-03-00-5	MURPHY CARLA	96.00
260-147-04-00-8	MC GOURTY DEAN	96.00
260-147-05-00-1	MC GOURTY DEAN	96.00
260-147-06-00-4	CAMBLIN THOMAS D & BEVERLY A TRUST	96.00
260-147-07-00-7	VAN BURT L JR & CATHERINE ANN	96.00
260-147-08-00-0	CLERICO FAMILY TRUST	96.00
260-147-09-00-3	CLERICO FAMILY TRUST	96.00
260-147-10-00-5	FOX JACQUES	96.00
260-147-11-00-8	CLERICO FAMILY TRUST	96.00
260-147-12-00-1	MA KYUNG HYUN & UN CHU	96.00
260-147-13-00-4	MARRACCINO TRUST	96.00
260-147-14-00-7	CLERICO FAMILY TRUST	96.00
260-147-15-00-0	BENNETT WILLIAM & FURBEE DIANE J	96.00
260-147-16-00-3	CLERICO FAMILY TRUST	96.00
260-147-17-00-6	CLERICO FAMILY TRUST	96.00
260-147-18-00-9	CLERICO FAMILY TRUST	96.00
260-147-19-00-2	CLERICO FAMILY TRUST	96.00
260-147-20-00-4	CLERICO FAMILY TRUST	96.00
260-147-21-00-7	WAGNER EARL E	96.00
260-147-22-00-0	CLERICO FAMILY TRUST	96.00
260-147-23-00-3	CLERICO FAMILY TRUST	96.00
260-147-24-00-6	ZUO PINGDI & CHEN LILI	96.00
260-147-25-00-9	ZUO PINGDI & CHEN LILI	96.00
260-147-26-00-2	ZUO PINGDI & CHEN LILI	96.00
260-147-27-00-5	ZUO PINGDI & CHEN LILI	96.00
260-147-28-00-8	ZUO PINGDI & CHEN LILI	96.00
260-147-29-00-1	ZUO PINGDI & CHEN LILI	96.00
260-147-30-00-3	SASO STEVEN MICHAEL	96.00
260-147-31-00-6	VAN BURT L & CATHERINE A	96.00
260-147-32-00-9	VAN BURT L JR & CATHERINE A	96.00
260-147-33-00-2	VAN BURT L & CATHERINE A	96.00

Frazier Park Public Utility District  
 Water Standby Assessment District No. 2025-1  
 Assessment Roll FY 2025/26

<u>Assessor's Parcel Number</u>	<u>Owner Name</u>	<u>Fiscal Year 2025/26 Levy</u>
260-147-34-00-5	VAN BURT JR & CATHY	96.00
260-147-35-01-7	HURST STANLEY P	96.00
260-147-35-02-6	HURST HILDA E TR ET AL	96.00
260-148-01-00-6	VAN BURT L JR & CATHERINE F	96.00
260-148-02-00-9	VAN BURT L JR & CATHERINE F	96.00
260-151-07-00-8	COOMBS ALAN WALTER	96.00
260-151-19-00-3	ANDREWS GAIL E & DIANA SUE REV LIV TR	96.00
260-151-24-00-7	ANDREWS DIANA S	96.00
260-151-27-00-6	COOMBS ALAN WALTER	96.00
260-151-28-00-9	CALL LINDSAY & NEAL	96.00
260-151-38-00-8	COUNTY OF KERN	96.00
260-151-39-00-1	ANDREWS GAIL E & DIANA SUE REV LIV TR	96.00
260-152-02-00-0	EDRINGTON FAMILY TRUST	96.00
260-152-03-00-3	EDRINGTON FAMILY TRUST	96.00
260-152-07-00-5	SUERO GERARD & RHODA	96.00
260-152-09-00-1	BURNS RICHARD A & DAWN	96.00
260-152-11-00-6	ANDREWS GAIL E & DIANA SUE REV LIV TR	96.00
260-152-16-00-1	BERTLES PAUL	96.00
260-152-20-00-2	PENNER REVOCABLE LIVING TRUST	96.00
260-152-23-00-1	BERTLES PAUL	96.00
260-152-27-00-3	VAN ESS DONA L	96.00
260-152-28-00-6	VAN ESS DONA L	96.00
260-152-29-00-9	BURNS TRUST	96.00
260-152-30-00-1	ORLOSSY GEORGE & MARILYN ET AL	96.00
260-152-31-00-4	COGAR CHRISTINA TR	96.00
260-152-32-00-7	COGAR CHRISTINA TR	96.00
260-152-33-00-0	CANYON PROPERTIES LLC	96.00
260-152-34-00-3	CANYON PROPERTIES LLC	96.00
260-152-35-00-6	COLITTI MICHAEL J	96.00
260-152-36-00-9	SMITH THOMAS J TRUST	96.00
260-153-01-00-4	COGAR CHRISTINA TR	96.00
260-153-02-00-7	COGAR CHRISTINA TR	96.00
260-153-03-00-0	COGAR CHRISTINA TR	96.00
260-153-05-00-6	FELIX GARY	96.00
260-153-09-00-8	GRIGORYAN ARMEN	96.00
260-153-10-00-0	GRIGORYAN ARMEN	96.00
260-153-15-00-5	GRIGORYAN ARMEN	96.00
260-153-16-00-8	BUNHEIRAO CHRISTOPHER DAVID	96.00
260-153-17-00-1	FULTON FLOYD M & KAYE M FULTON TRUST	96.00
260-153-18-00-4	FULTON FLOYD M & KAYE M FULTON TRUST	96.00
260-153-19-00-7	COGAR CHRISTINA TR	96.00
260-153-20-00-9	COGAR CHRISTINA TR	96.00

Frazier Park Public Utility District  
 Water Standby Assessment District No. 2025-1  
 Assessment Roll FY 2025/26

<u>Assessor's Parcel Number</u>	<u>Owner Name</u>	<u>Fiscal Year 2025/26 Levy</u>
260-154-02-00-4	FLORES ALFRED M & OLIVIA M FMLY TR	96.00
260-154-03-00-7	FLORES OLIVIA M	96.00
260-154-05-00-3	FLORES OLIVIA M	96.00
260-154-06-00-6	FLORES OLIVIA M	96.00
260-154-07-00-9	BENDER WISWELL AUNDREA M	96.00
260-154-11-00-0	HYETT MAURICE C & ELIZABETH B	96.00
260-154-12-00-3	FLORES OLIVIA M	96.00
260-154-14-00-9	FLORES OLIVIA M	96.00
260-154-15-00-2	NOYES BRENDA S	96.00
260-154-16-00-5	REAVELY LINDA K TRUST	96.00
260-154-20-00-6	CAZAREZ MARTIN	96.00
260-155-01-00-8	EVANS STEVE	96.00
260-155-02-00-1	KISLAN BARBARA M	96.00
260-155-03-00-4	BABICH BRIAN T	96.00
260-155-04-00-7	BABICH BRIAN T	96.00
260-155-05-00-0	BABICH BRIAN T	96.00
260-155-06-00-3	MARRACCINO TRUST	96.00
260-155-08-00-9	BAKER CARL W & SHIRLEY A	96.00
260-155-09-00-2	BAKER CARL W & SHIRLEY A	96.00
260-155-10-00-4	MARRACCINO TRUST	96.00
260-155-14-00-6	MARRACCINO TRUST	96.00
260-155-15-00-9	MARRACCINO TRUST	96.00
260-155-16-00-2	MARRACCINO TRUST	96.00
260-155-17-00-5	MARRACCINO TRUST	96.00
260-160-09-00-0	KHALIL SAMEER F & ENSAT LIV TR	96.00
260-160-17-00-3	JONES ANN L	96.00
260-160-19-00-9	MMAC PROP LLC	96.00
260-160-23-00-0	KANE FAMILY TRUST	96.00
260-170-01-00-9	THOMAS NEIL JOHN	96.00
260-170-02-00-2	VAN BURT L	96.00
<b>1,248 Parcels</b>	<b>Total Levy \$</b>	<b>119,808.00</b>

## 8. References

---

*Beutz v. Cnty. of Riverside*, 184 Cal. App. 4th 1516, 1532 (2010).

*Broad Beach Geologic Hazard Abatement District v 31506 Victoria Point LLC*, B304699 (81 Cal. App. 5th 1068, 1090 (2022)).

*Town of Tiburon v. Bonander*, 180 Cal. App. 4th 1057, 1084 (2009)

*Golden Hill Neighborhood Assn. v. City of San Diego CA4/1*, D062203 (199 Cal. App. 4th 416, 438 (2011))

*Silicon Valley Taxpayers' Association Incorporated v. Santa Clara County Open Space Authority*, 44 Cal. 4th 431 (2008).